

ALLOTMENT 667 in DEV. NO.292/D066/2012

in the area named

MUNNO PARA WEST

CT ---/---

PRELIMINARY

IMPORTANT
 SERVICE AND DRIVEWAY LOCATIONS
 ARE APPROXIMATE. ANY CHANGES WILL
 BE AT THE PURCHASERS EXPENSE.
 PURCHASER: _____
 PURCHASER: _____
 DATE: _____

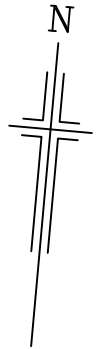

LEVANT STREET

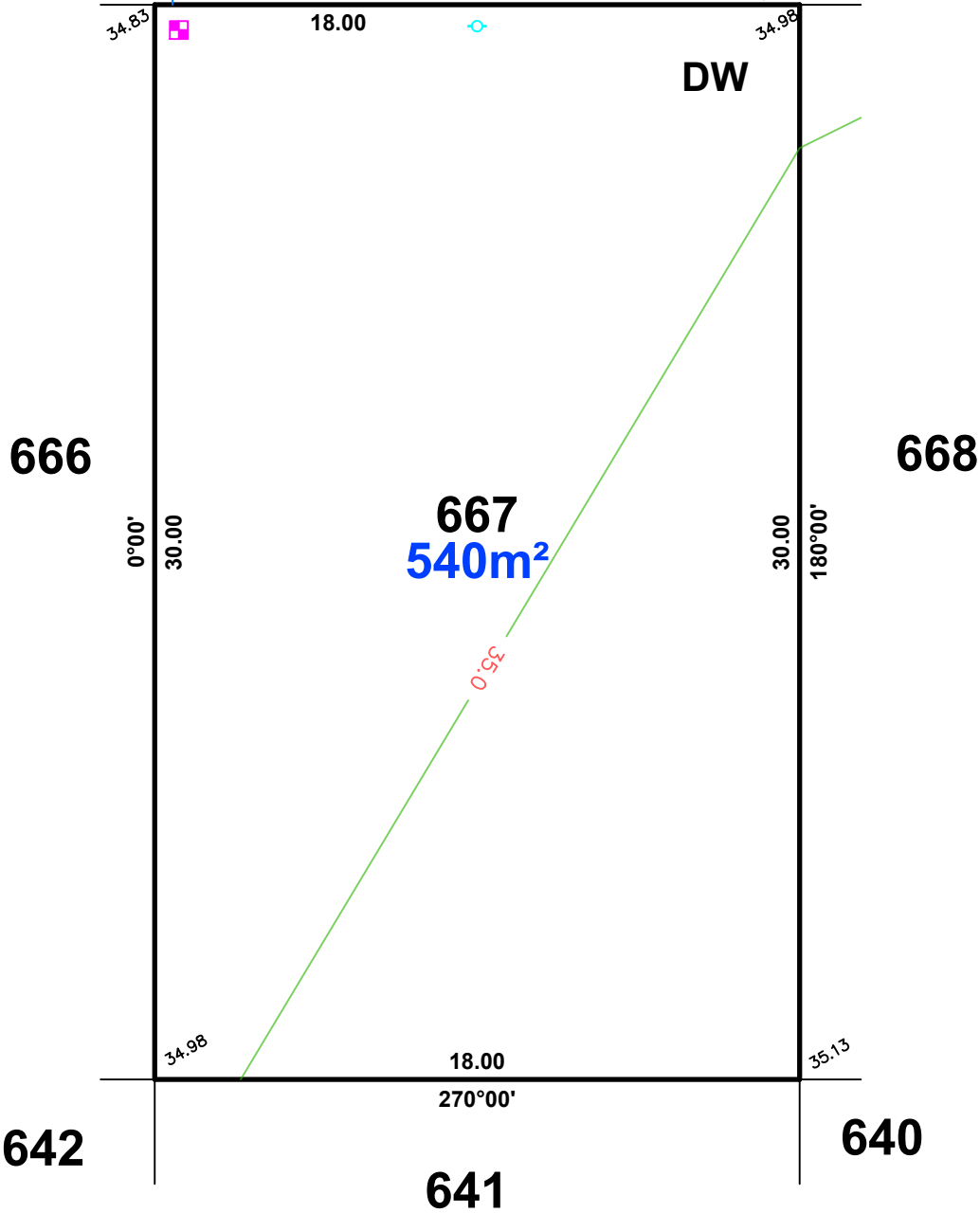
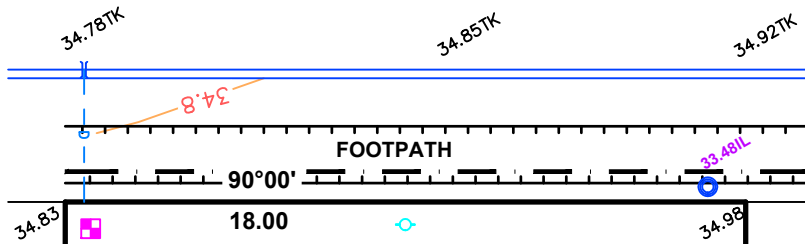

LEGEND

- WATER METER
- SIP SEWER IP
- STOBIE POLE
- TELSTRA PIT
- S/W GRATING
- SEWER MAN HOLE
- S/W MANHOLE
- LIGHT POLE
- ETSA CONNECTION
- BOLLARD
- SIGN
- S/W CONNECTION
- FOOTPATH
- SIDE ENTRY PIT
- COMMON SERVICE TRENCH
- DOMESTIC
- SEWER IO
- PROPOSED DOUBLE DRIVEWAY



1:200

ALLOTMENT 668 in DEV. NO.292/D066/2012

in the area named

MUNNO PARA WEST

CT ---/---

PRELIMINARY

IMPORTANT
 SERVICE AND DRIVEWAY LOCATIONS
 ARE APPROXIMATE. ANY CHANGES WILL
 BE AT THE PURCHASERS EXPENSE.
 PURCHASER: _____
 PURCHASER: _____
 DATE: _____

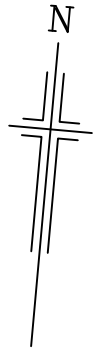

LEVANT STREET

YAMUNA AVENUE

667

668
400m²

641

640

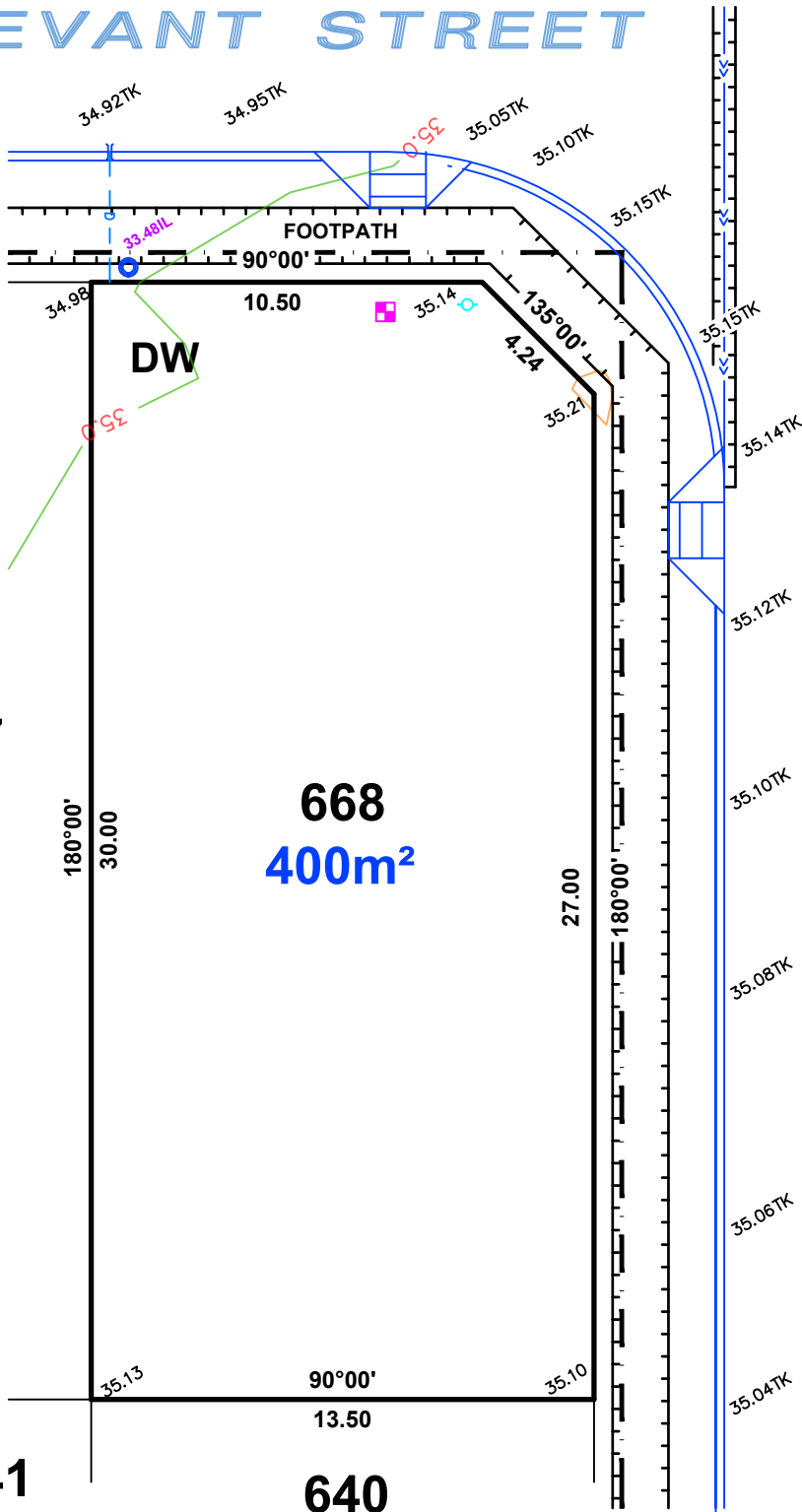

LEGEND

- WATER METER
- SIP SEWER IP
- STOBIE POLE
- TELSTRA PIT
- S/W GRATING
- SEWER MAN HOLE
- S/W MANHOLE
- LIGHT POLE
- ETSA CONNECTION
- BOLLARD
- SIGN
- S/W CONNECTION
- FOOTPATH
- SIDE ENTRY PIT
- COMMON SERVICE TRENCH
- DOMESTIC
- SEWER IO
- DW PROPOSED DOUBLE DRIVEWAY



ALLOTMENT 712 in DEV. NO.292/D066/2012

in the area named

MUNNO PARA WEST

CT ---/---

PRELIMINARY

IMPORTANT
 SERVICE AND DRIVEWAY LOCATIONS
 ARE APPROXIMATE. ANY CHANGES WILL
 BE AT THE PURCHASERS EXPENSE.
 PURCHASER: _____
 PURCHASER: _____
 DATE: _____

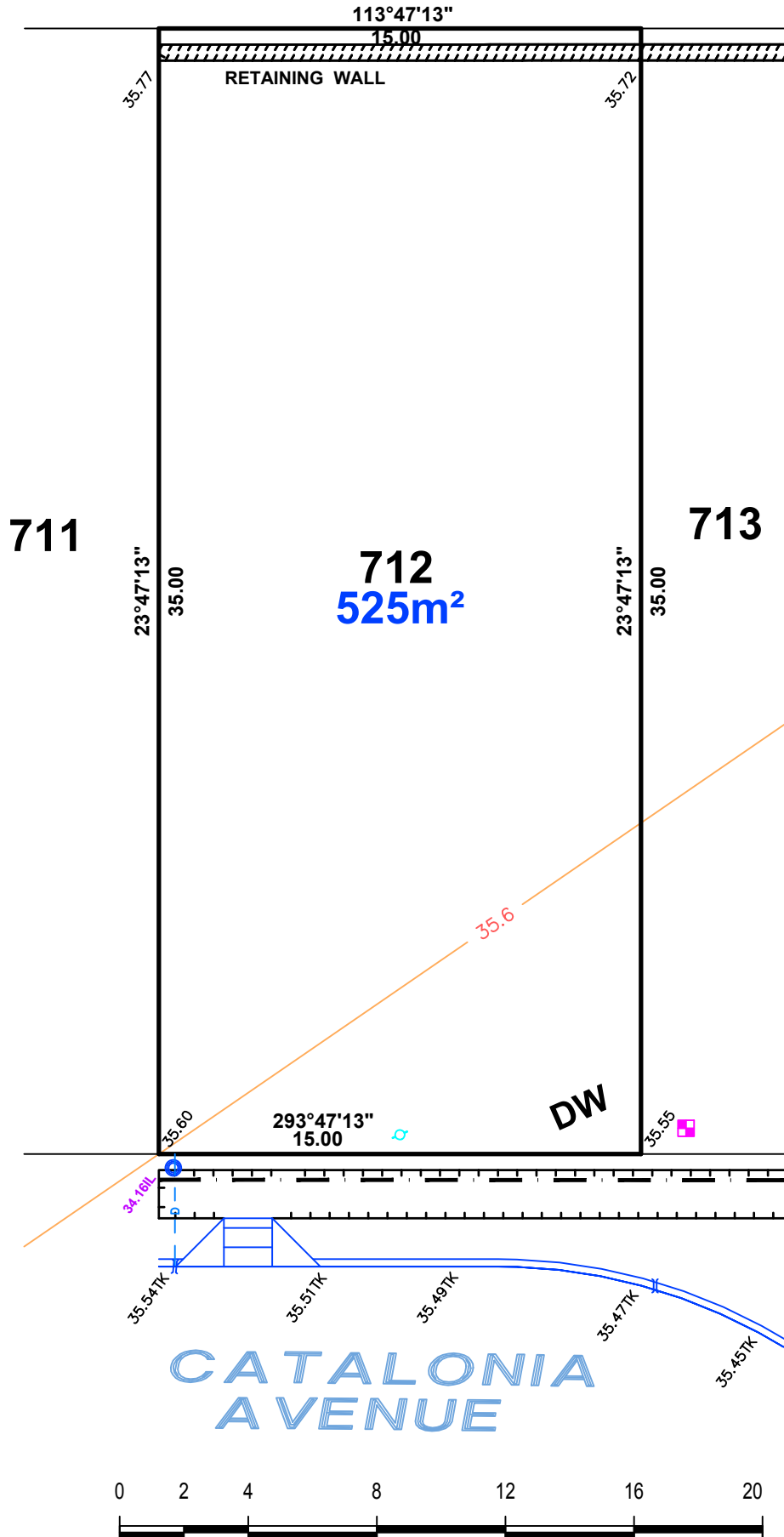

LEGEND

- TAP
- SEWER IP
- STOBIE POLE
- TELSTRA PIT
- S/W GRATING
- SEWER MAN HOLE
- S/W MANHOLE
- LIGHT POLE
- E.T.S.A CONNECTION
- BOLLARD
- SIGN
- S/W CONNECTION
- FOOTPATH
- SIDE ENTRY PIT
- COMMON SERVICE TRENCH
- DOMESTIC
- SEWER IO
- PROPOSED DOUBLE DRIVEWAY



ALLOTMENT 713 in DEV. NO.292/D066/2012

in the area named

MUNNO PARA WEST

CT ---/---

PRELIMINARY

IMPORTANT
 SERVICE AND DRIVEWAY LOCATIONS
 ARE APPROXIMATE. ANY CHANGES WILL
 BE AT THE PURCHASERS EXPENSE.
 PURCHASER: _____
 PURCHASER: _____
 DATE: _____

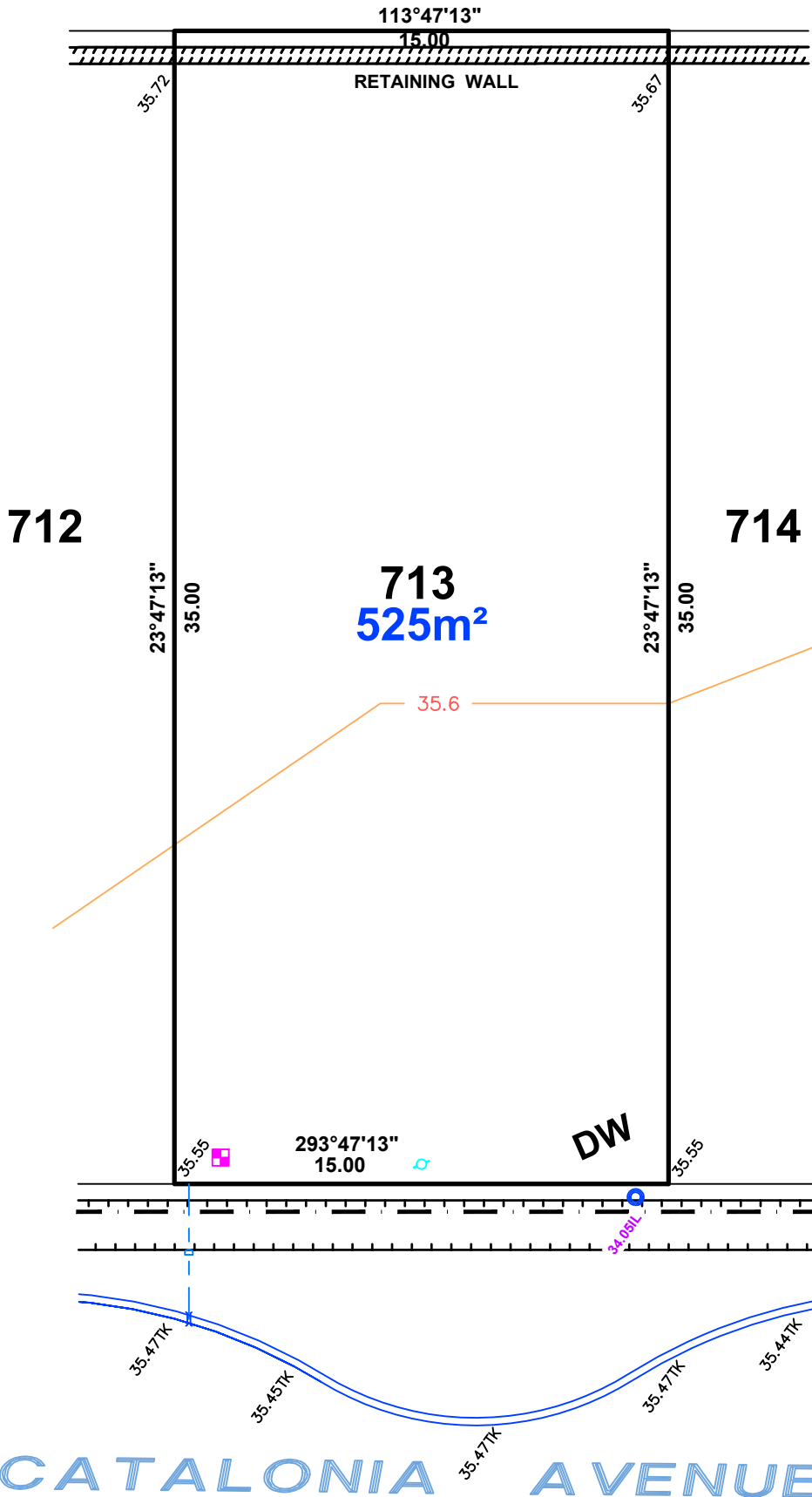
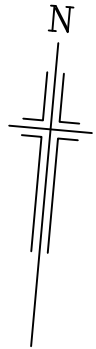

LEGEND

- TAP
- SEWER IP
- STOBIE POLE
- TELSTRA PIT
- S/W GRATING
- SEWER MAN HOLE
- S/W MANHOLE
- LIGHT POLE
- ETSA CONNECTION
- BOLLARD
- SIGN
- S/W CONNECTION
- FOOTPATH
- SIDE ENTRY PIT
- COMMON SERVICE TRENCH
- DOMESTIC
- SEWER IO
- DW PROPOSED DOUBLE DRIVEWAY



1:200

IMPORTANT
 SERVICE AND DRIVEWAY LOCATIONS
 ARE APPROXIMATE. ANY CHANGES WILL
 BE AT THE PURCHASERS EXPENSE.
 PURCHASER: _____
 PURCHASER: _____
 DATE: _____

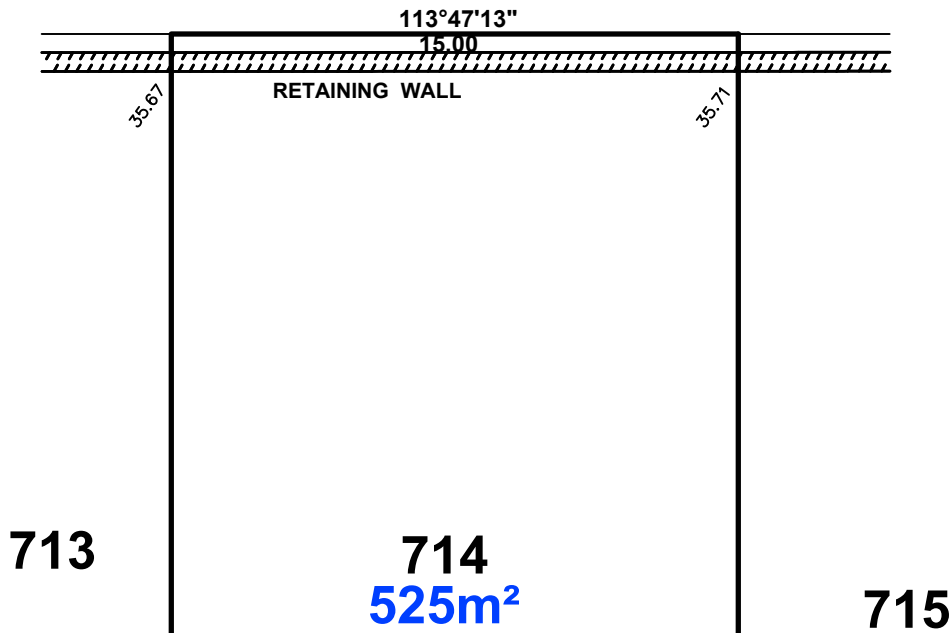
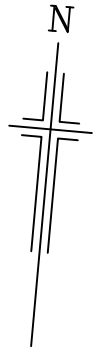

LEGEND

- TAP
- SEWER IP
- STOBIE POLE
- TELSTRA PIT
- SW GRATING
- SEWER MAN HOLE
- SW MANHOLE
- LIGHT POLE
- ETSA CONNECTION
- BOLLARD
- SIGN
- SW CONNECTION
- FOOTPATH
- SIDE ENTRY PIT
- COMMON SERVICE TRENCH
- DOMESTIC
- SEWER IO
- DW** PROPOSED DOUBLE DRIVEWAY

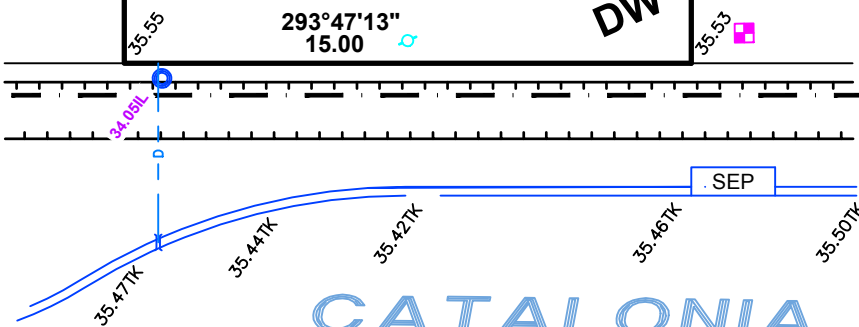

CATALONIA AVENUE



ALLOTMENT 715 in DEV. NO.292/D066/2012

in the area named
MUNNO PARA WEST

CT ---/---

PRELIMINARY

IMPORTANT
SERVICE AND DRIVEWAY LOCATIONS
ARE APPROXIMATE. ANY CHANGES WILL
BE AT THE PURCHASERS EXPENSE.
PURCHASER: _____
PURCHASER: _____
DATE: _____

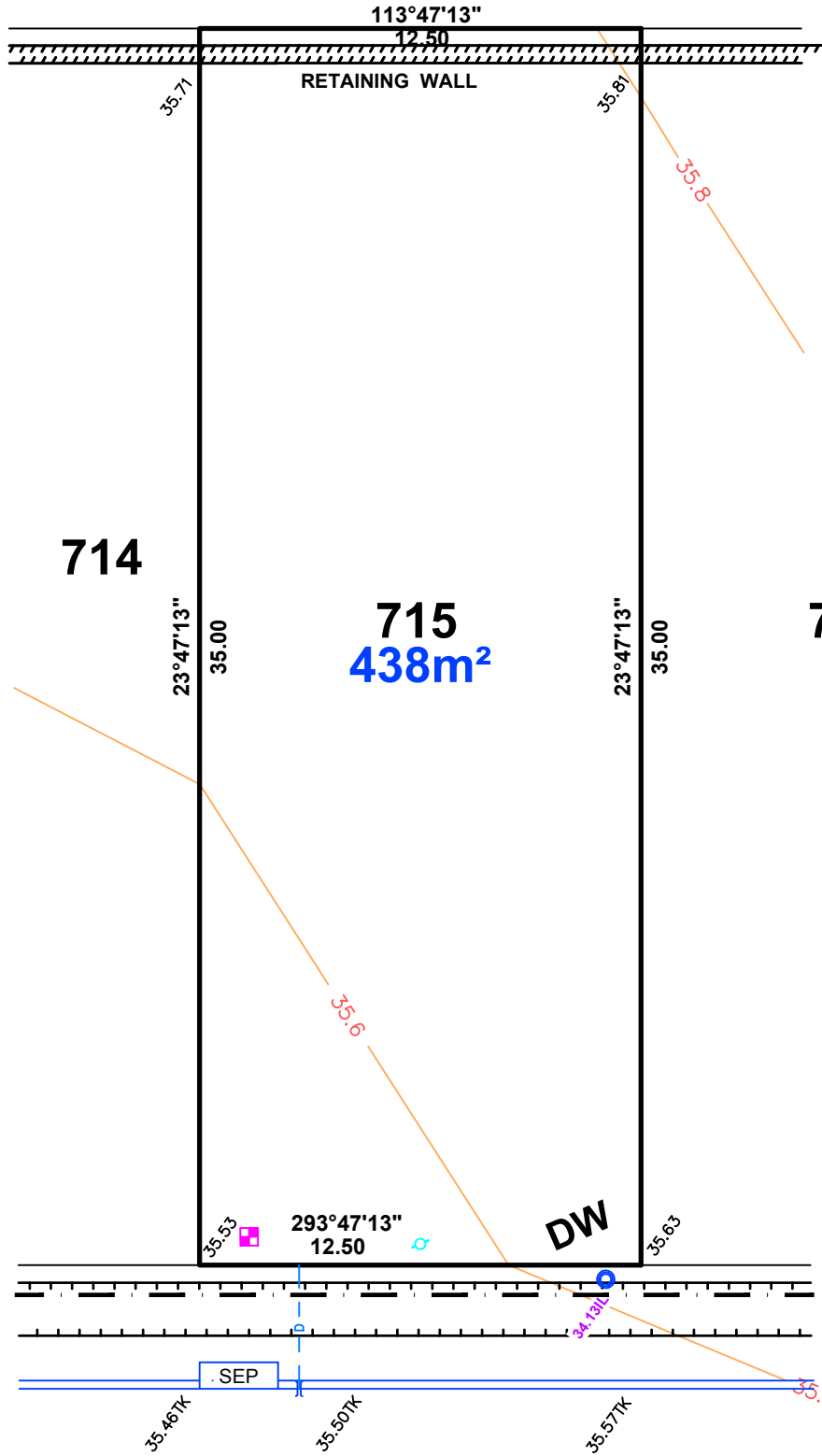
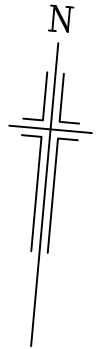

LEGEND

- TAP
- SEWER IP
- STOBIE POLE
- TELSTRA PIT
- S/W GRATING
- SEWER MAN HOLE
- S/W MANHOLE
- LIGHT POLE
- E.T.S.A CONNECTION
- BOLLARD
- SIGN
- S/W CONNECTION
- FOOTPATH
- SIDE ENTRY PIT
- COMMON SERVICE TRENCH
- DOMESTIC
- SEWER IO
- DW PROPOSED DOUBLE DRIVEWAY

CATALONIA AVENUE



1:200

ALLOTMENT 716 in DEV. NO.292/D066/2012

in the area named

MUNNO PARA WEST

CT ---/----

PRELIMINARY

IMPORTANT
 SERVICE AND DRIVEWAY LOCATIONS
 ARE APPROXIMATE. ANY CHANGES WILL
 BE AT THE PURCHASERS EXPENSE.
 PURCHASER: _____
 PURCHASER: _____
 DATE: _____

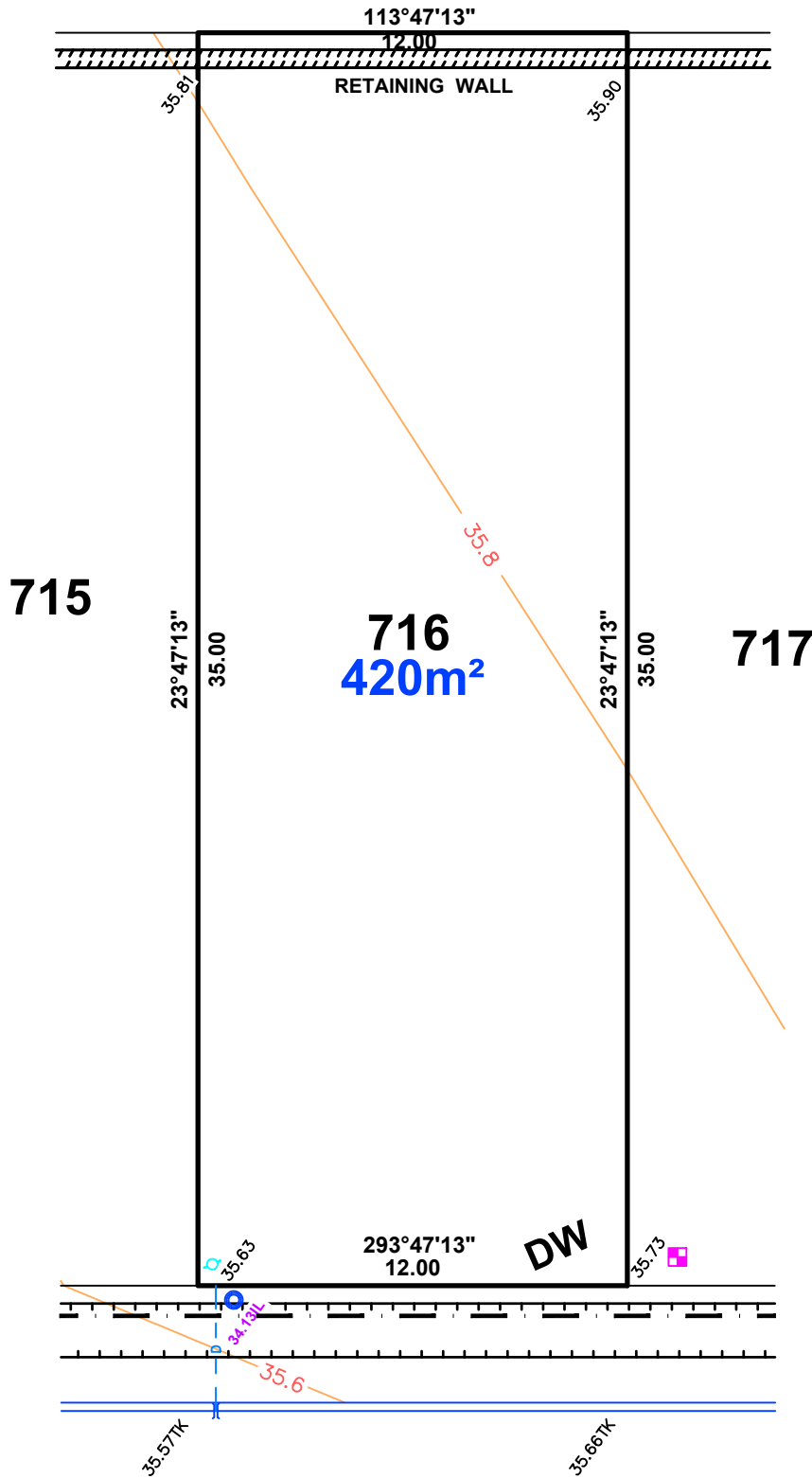
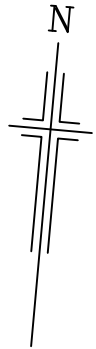

LEGEND

- TAP
- SEWER IP
- STOBIE POLE
- TELSTRA PIT
- S/W GRATING
- SEWER MAN HOLE
- S/W MANHOLE
- LIGHT POLE
- E.T.S.A CONNECTION
- BOLLARD
- SIGN
- S/W CONNECTION
- FOOTPATH
- SIDE ENTRY PIT
- COMMON SERVICE TRENCH
- DOMESTIC
- SEWER IO
- DW PROPOSED DOUBLE DRIVEWAY



1:200

ALLOTMENT 732 in DEV. NO.292/D066/2012
 in the area named
 MUNNO PARA WEST
 CT ---/----

PRELIMINARY

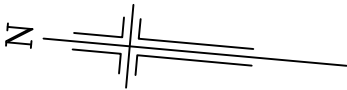

733

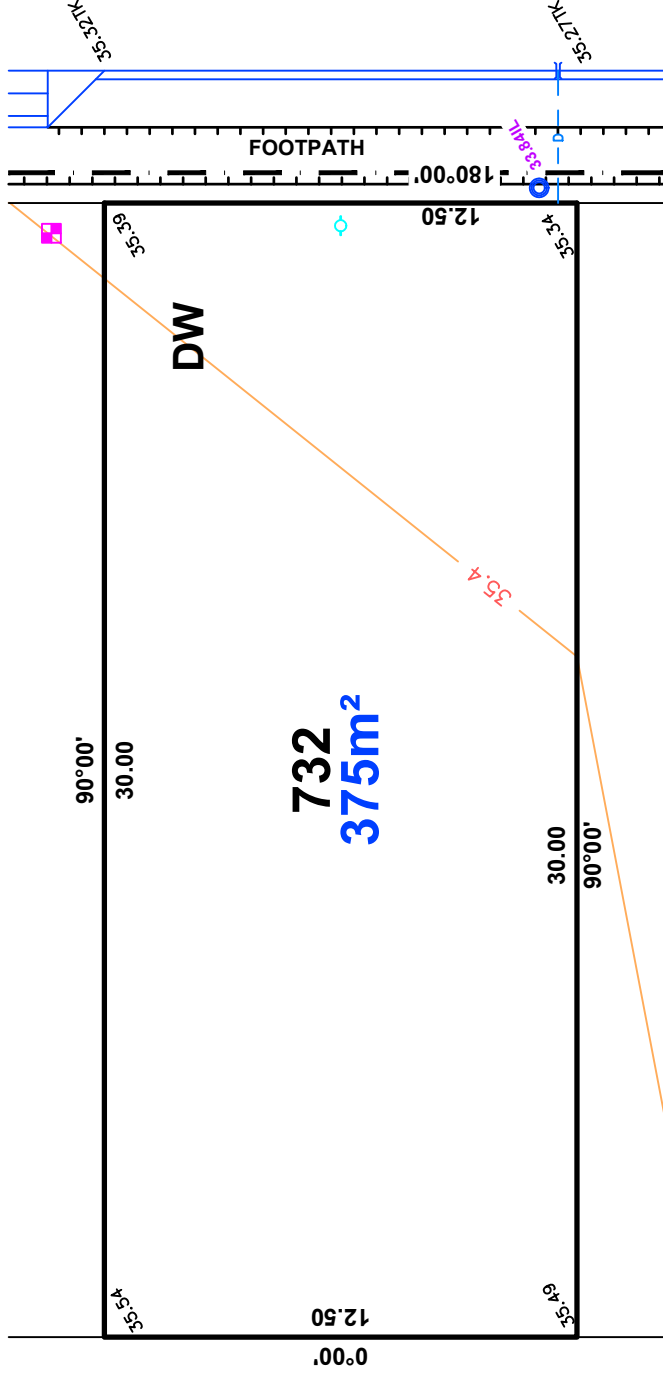

YAMUNA AVENUE

LEGEND

- WATER METER
- SIP
- STOBIE POLE
- TELSTRA PIT
- S/W GRATING
- SEWER MAN HOLE
- S/W MANHOLE
- LIGHT POLE
- ETSA CONNECTION
- BOLLARD
- SIGN
- S/W CONNECTION
- FOOTPATH
- SIDE ENTRY PIT
- COMMON SERVICE TRENCH
- DOMESTIC
- SEWER IO
- DW

IMPORTANT
 SERVICE AND DRIVEWAY LOCATIONS
 ARE APPROXIMATE. ANY CHANGES WILL
 BE AT THE PURCHASERS EXPENSE.
 PURCHASER: _____
 DATE: _____

ALEXANDER SYMONDS
 PH 8130 1666

1:200

ALLOTMENT 733 in DEV. NO.292/D066/2012
 in the area named
 MUNNO PARA WEST
 CT ---/----

PRELIMINARY

734

733
 300m²

732

727

728

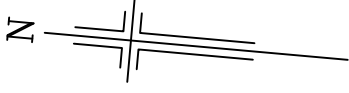

YAMUNA AVENUE

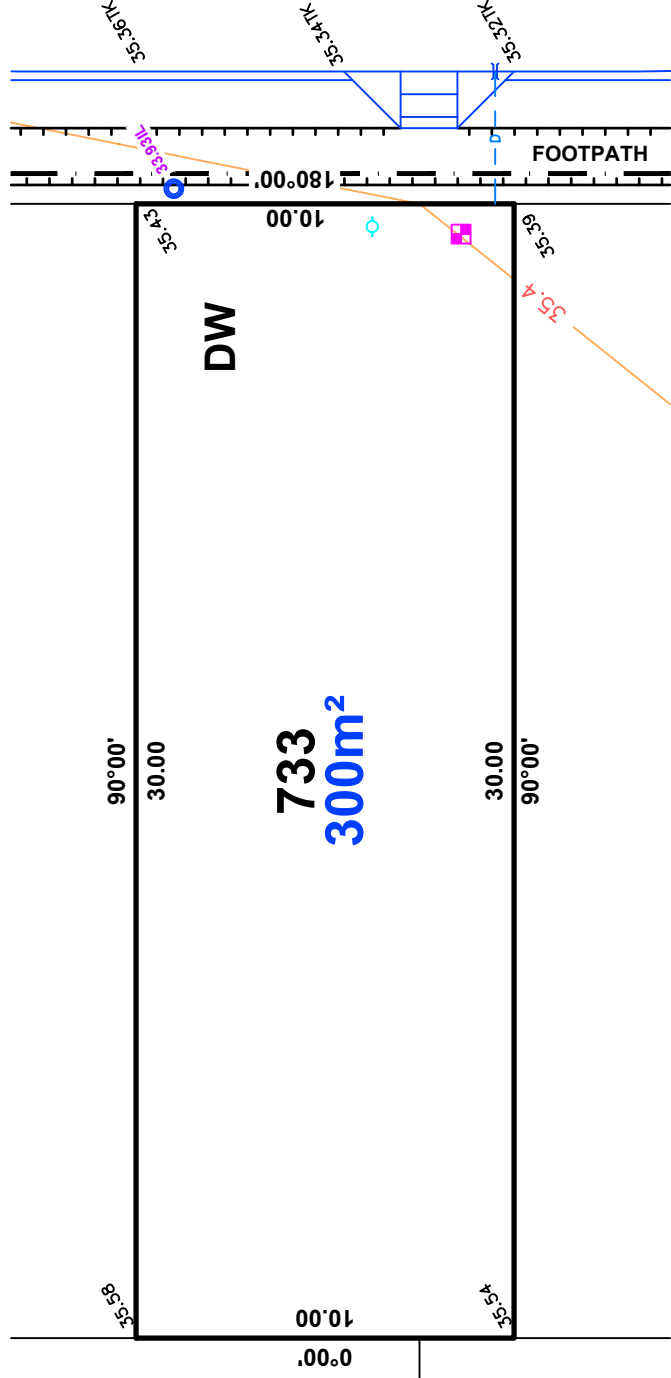

LEGEND

- WATER METER
- SIP
- SEWER IP
- STOBIE POLE
- TELSTRA PIT
- S/W GRATING
- SEWER MAN HOLE
- S/W MANHOLE
- LIGHT POLE
- ETSA CONNECTION
- BOLLARD
- SIGN
- S/W CONNECTION
- FOOTPATH
- SIDE ENTRY PIT
- COMMON SERVICE TRENCH
- DOMESTIC
- SEWER IO
- DW PROPOSED DOUBLE DRIVEWAY

IMPORTANT
 SERVICE AND DRIVEWAY LOCATIONS
 ARE APPROXIMATE. ANY CHANGES WILL
 BE AT THE PURCHASERS EXPENSE.
 PURCHASER: _____
 DATE: _____

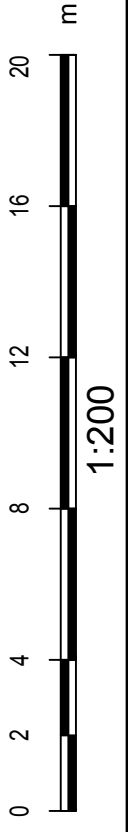

ALEXANDER SYMONDS
 PH 8130 1666

ALLOTMENT 734 in DEV. NO.292/D066/2012
 in the area named
MUNNO PARA WEST
 CT ---/---

PRELIMINARY

CATALONIA AVENUE

YAMUNA AVENUE

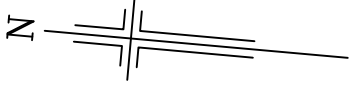

LEGEND

- WATER METER
- SIP
- SEWER IP
- STOBIE POLE
- TELSTRA PIT
- S/W GRATING
- SEWER MAN HOLE
- S/W MANHOLE
- LIGHT POLE
- ETSA CONNECTION
- BOLLARD
- SIGN
- S/W CONNECTION
- FOOTPATH
- SIDE ENTRY PIT
- COMMON SERVICE TRENCH
- DOMESTIC
- SEWER IO
- DW PROPOSED DOUBLE DRIVEWAY

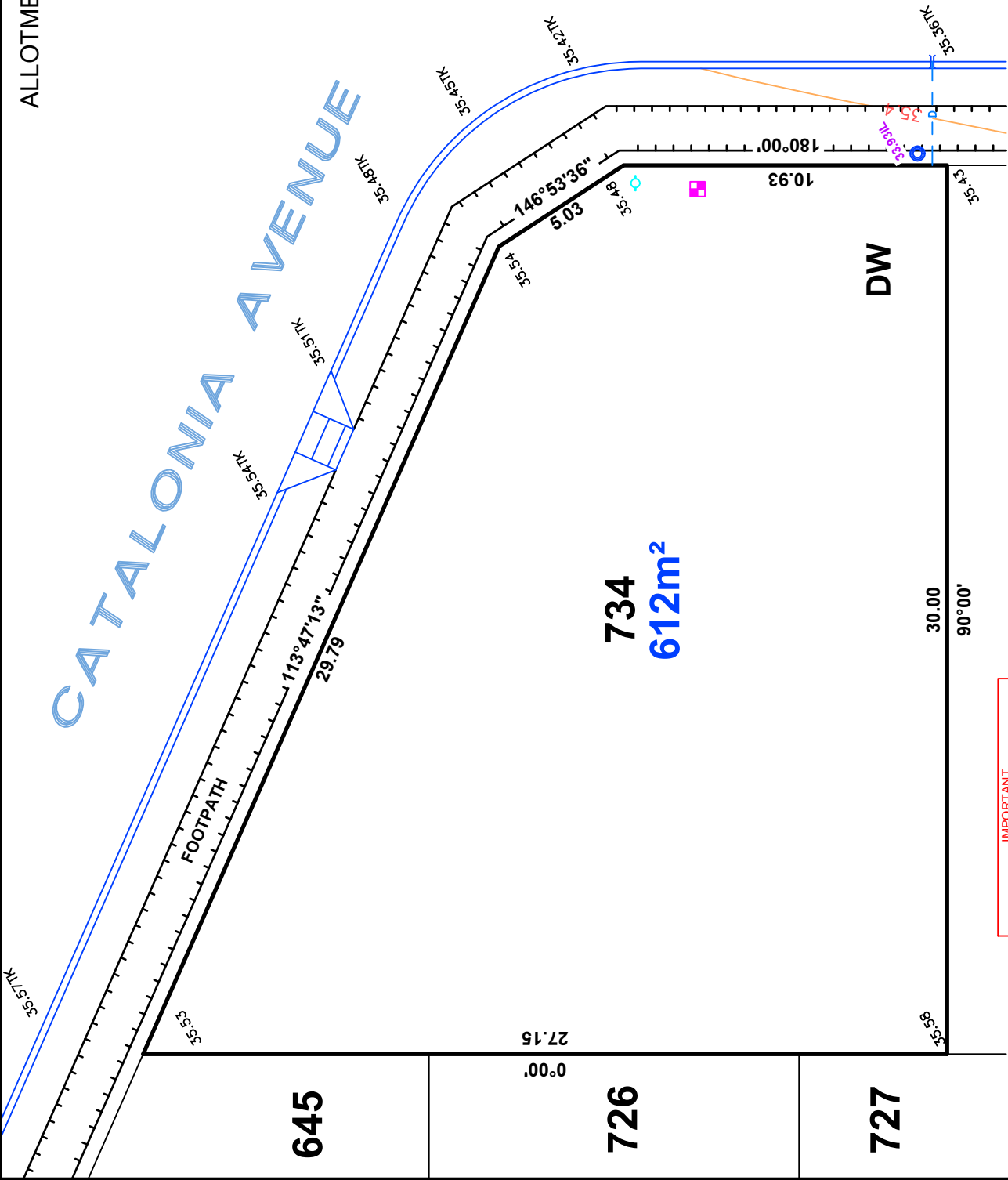

IMPORTANT
 SERVICE AND DRIVEWAY LOCATIONS
 ARE APPROXIMATE. ANY CHANGES WILL
 BE AT THE PURCHASERS EXPENSE.
 PURCHASER: _____
 PURCHASER: _____
 DATE: _____

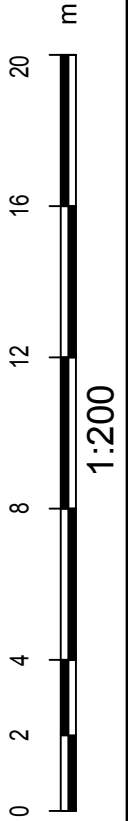

ALEXANDER SYMONDS
 PH 8130 1666

ALLOTMENT 799 in DEV. NO.292/D066/2012

in the area named

MUNNO PARA WEST

CT ---/----

PRELIMINARY

IMPORTANT
 SERVICE AND DRIVEWAY LOCATIONS
 ARE APPROXIMATE. ANY CHANGES WILL
 BE AT THE PURCHASERS EXPENSE.
 PURCHASER: _____
 PURCHASER: _____
 DATE: _____

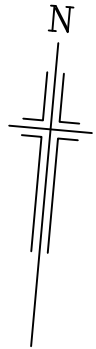

MURCIA AVENUE

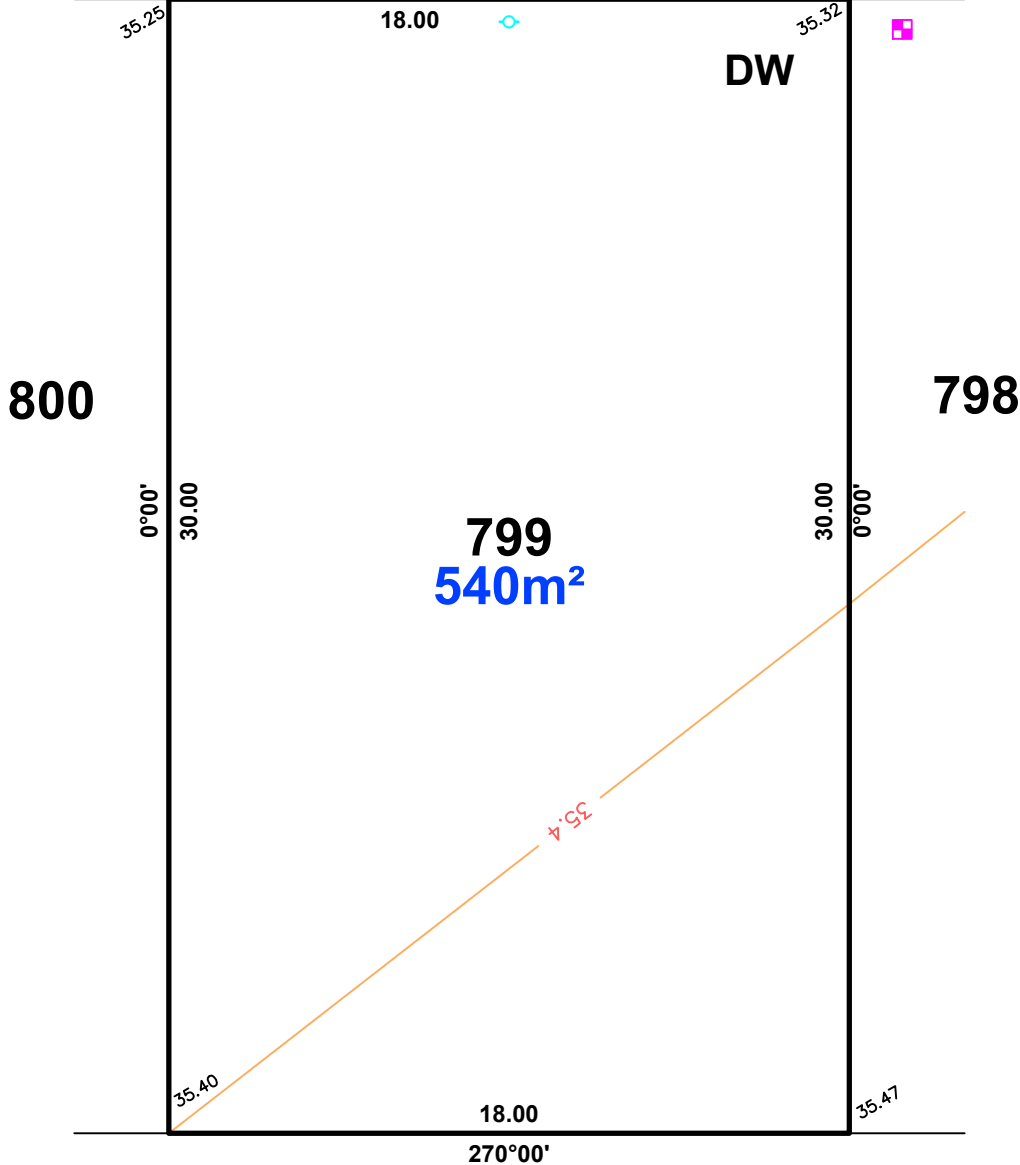
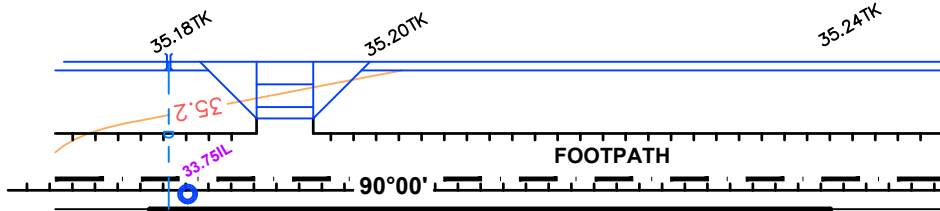

LEGEND

- WATER METER
- SIP SEWER IP
- STOBIE POLE
- TELSTRA PIT
- S/W GRATING
- SEWER MAN HOLE
- S/W MANHOLE
- LIGHT POLE
- ETSA CONNECTION
- BOLLARD
- SIGN
- S/W CONNECTION
- FOOTPATH
- SIDE ENTRY PIT
- COMMON SERVICE TRENCH
- DOMESTIC
- SEWER IO
- DW** PROPOSED DOUBLE DRIVEWAY



ALLOTMENT 800 in DEV. NO.292/D066/2012

in the area named

MUNNO PARA WEST

CT ---/---

PRELIMINARY

IMPORTANT
SERVICE AND DRIVEWAY LOCATIONS
ARE APPROXIMATE. ANY CHANGES WILL
BE AT THE PURCHASERS EXPENSE.
PURCHASER: _____
PURCHASER: _____
DATE: _____

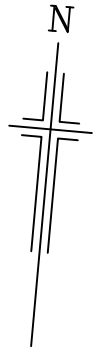

MURCIA AVENUE

YAMUNA AVENUE

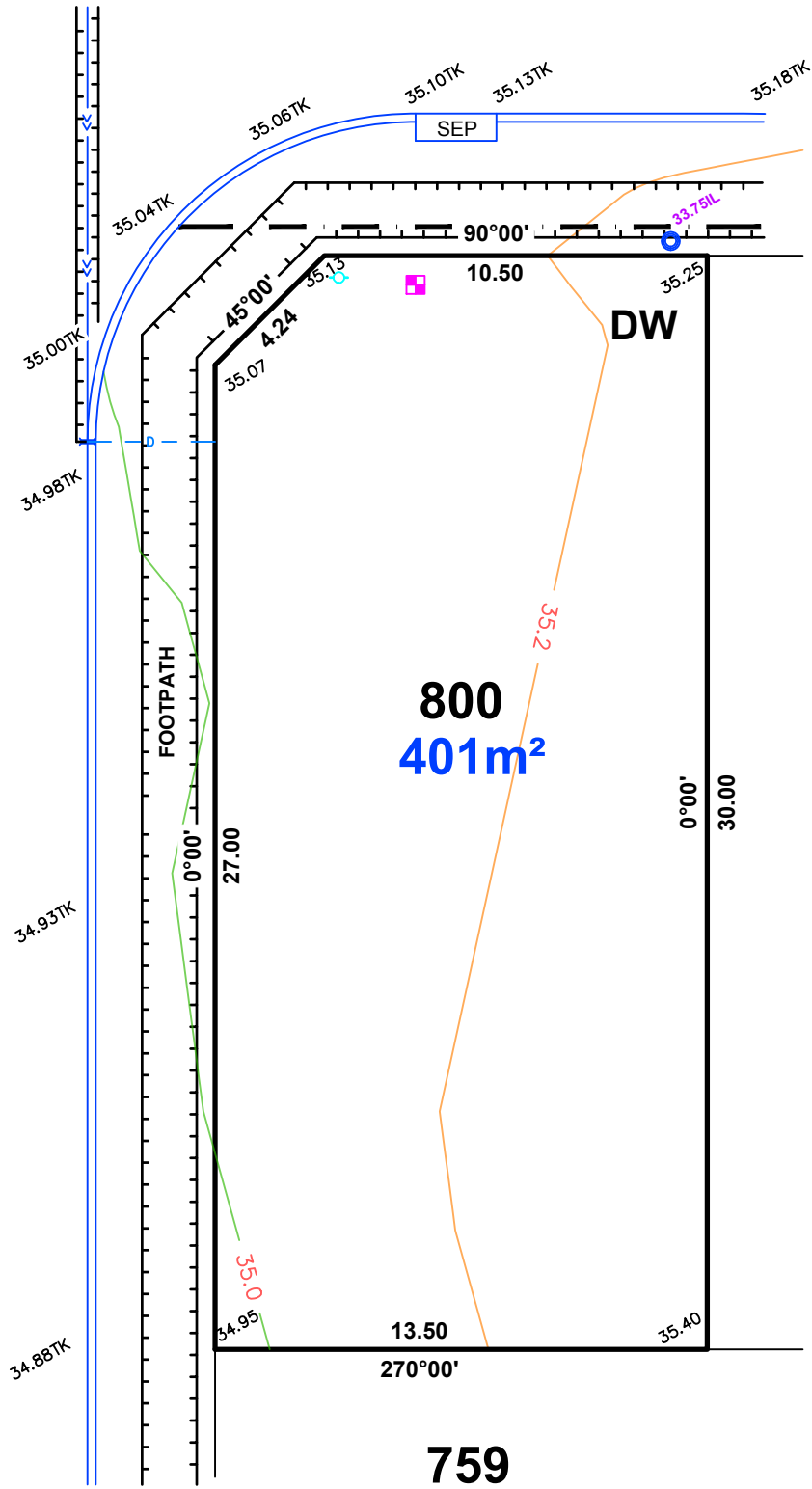

LEGEND

- WATER METER
- SIP SEWER IP
- STOBIE POLE
- TELSTRA PIT
- S/W GRATING
- SEWER MAN HOLE
- S/W MANHOLE
- LIGHT POLE
- ETSA CONNECTION
- BOLLARD
- SIGN
- S/W CONNECTION
- FOOTPATH
- SIDE ENTRY PIT
- COMMON SERVICE TRENCH
- DOMESTIC
- SEWER IO
- PROPOSED DOUBLE DRIVEWAY

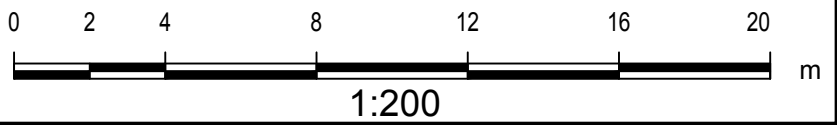

ALLOTMENT 901 in DEV. NO.292/D066/2012
 in the area named
 MUNNO PARA WEST
 CT ---/-----

PRELIMINARY

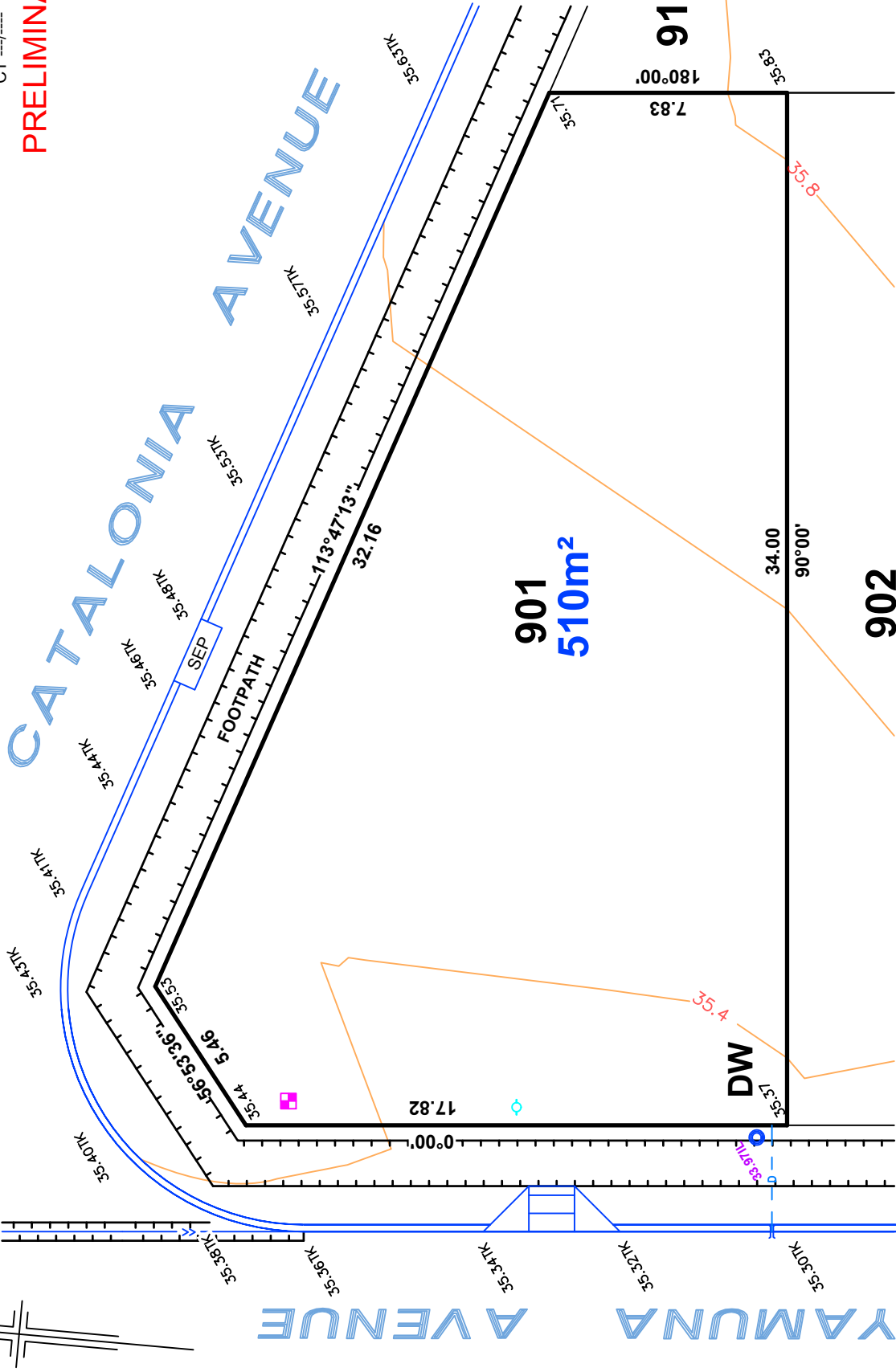

LEGEND

- WATER METER
- SIP SEWER IP
- STOBIE POLE
- TELSTRA PIT
- ▨ S/W GRATING
- SEWER MAN HOLE
- S/W MANHOLE
- ★ LIGHT POLE
- ETSA CONNECTION
- BOLLARD
- SIGN
- S/W CONNECTION
- FOOTPATH
- SIDE ENTRY PIT
- COMMON SERVICE TRENCH
- - - DOMESTIC
- SEWER IO
- DW PROPOSED DOUBLE DRIVEWAY

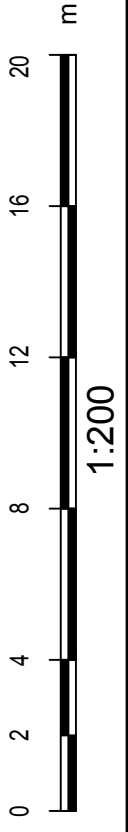

IMPORTANT
 SERVICE AND DRIVEWAY LOCATIONS
 ARE APPROXIMATE. ANY CHANGES WILL
 BE AT THE PURCHASERS EXPENSE.
 PURCHASER: _____
 DATE: _____

ALEXANDER SYMONDS
 PH 8130 1666

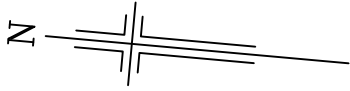

ALLOTMENT 902 in DEV. NO.292/D066/2012
 in the area named
 MUNNO PARA WEST
 CT ---/-----

PRELIMINARY

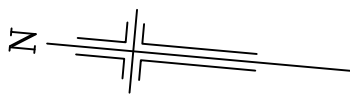

YAMUNA AVENUE

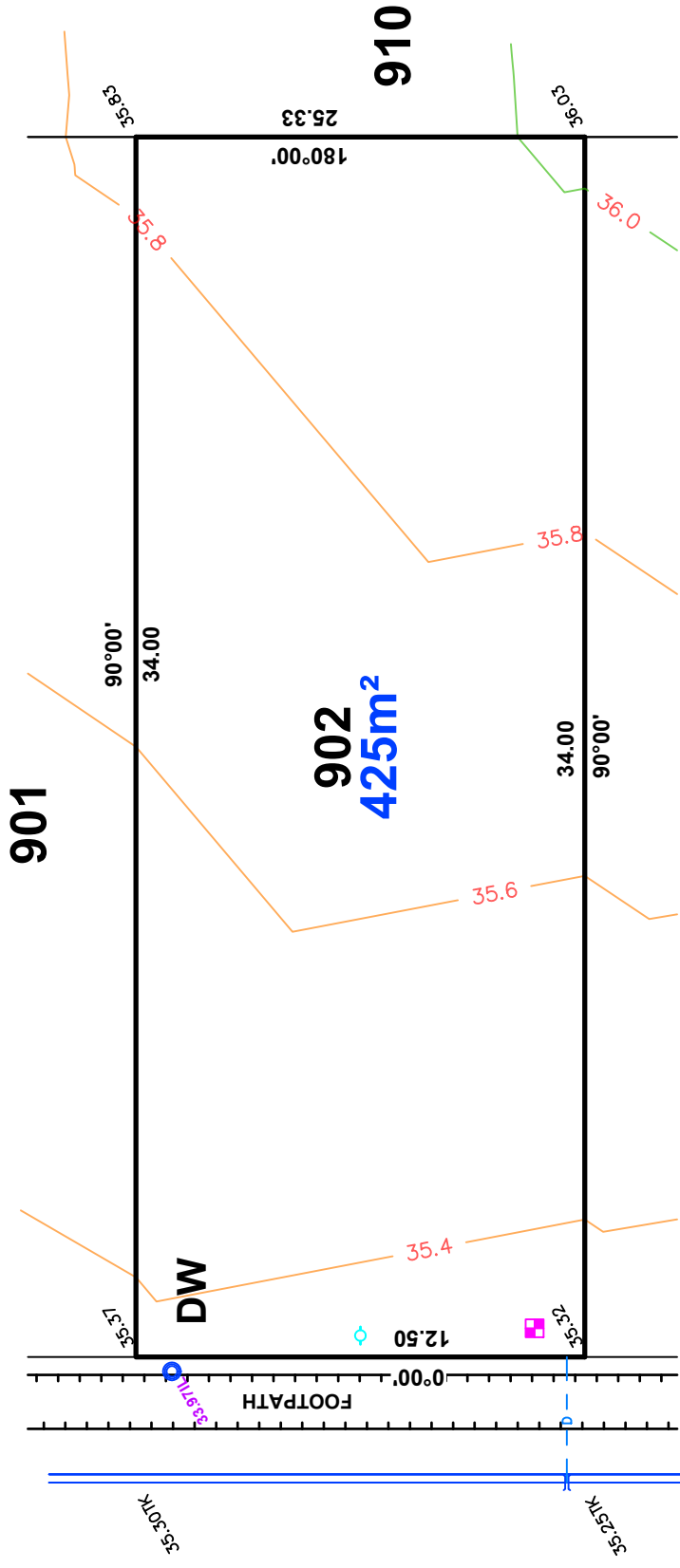

LEGEND

- WATER METER
- SIP
- SEWER IP
- STOBIE POLE
- TELSTRA PIT
- ▨ S/W GRATING
- SEWER MAN HOLE
- S/W MANHOLE
- * LIGHT POLE
- ETSA CONNECTION
- BOLLARD
- SIGN
- S/W CONNECTION
- FOOTPATH
- SIDE ENTRY PIT
- COMMON SERVICE TRENCH
- - - DOMESTIC
- SEWER IO
- DW PROPOSED DOUBLE DRIVEWAY

IMPORTANT
 SERVICE AND DRIVEWAY LOCATIONS
 ARE APPROXIMATE. ANY CHANGES WILL
 BE AT THE PURCHASERS EXPENSE.
 PURCHASER: _____
 PURCHASER: _____
 DATE: _____

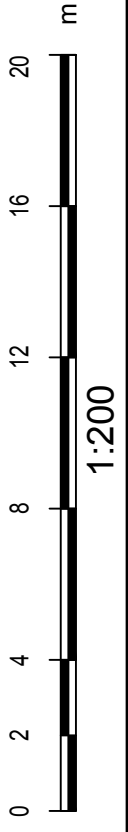

ALLOTMENT 903 in DEV. NO.292/D066/2012
 in the area named
 MUNNO PARA WEST
 CT ---/----

PRELIMINARY

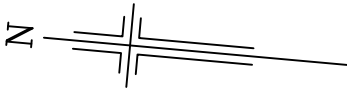

YAMUNA AVENUE

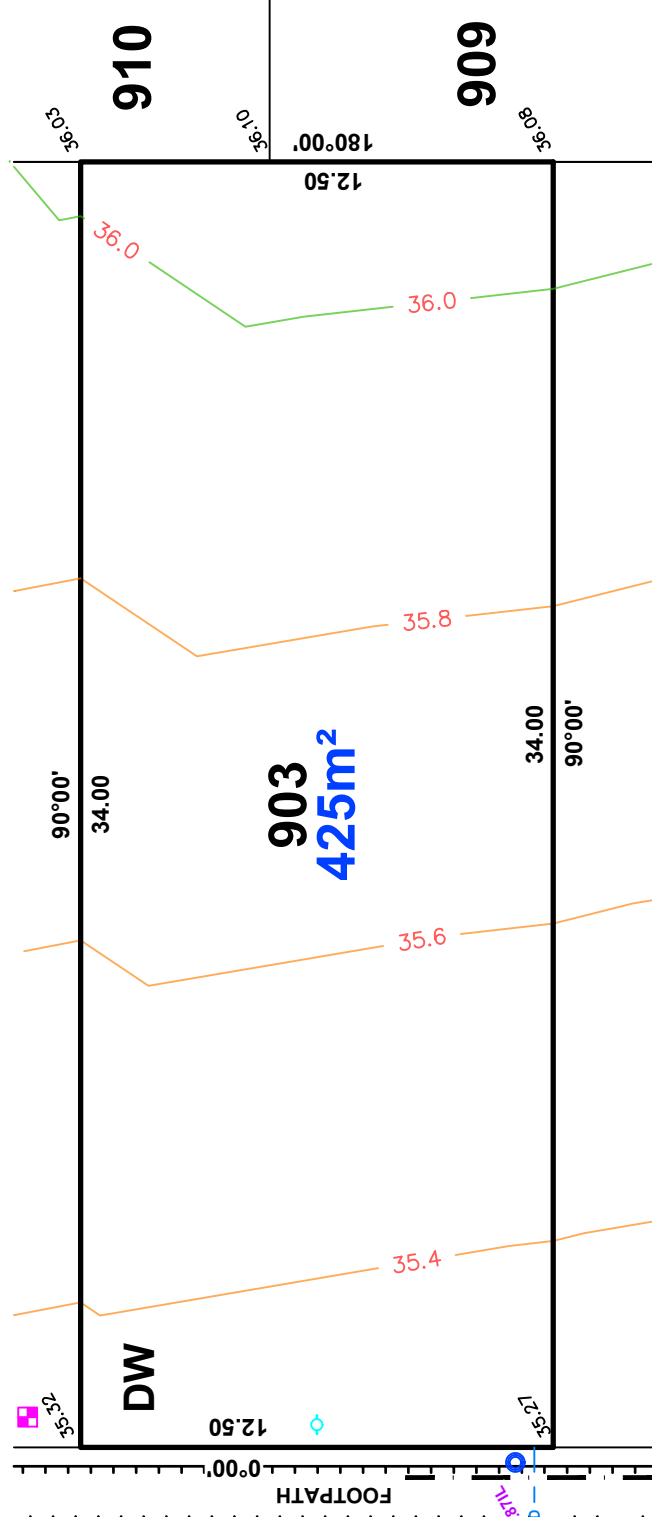

LEGEND

- WATER METER
- SIP
- STOBIE POLE
- TELSTRA PIT
- ▨ S/W GRATING
- SEWER MAN HOLE
- S/W MANHOLE
- ★ LIGHT POLE
- ETSA CONNECTION
- BOLLARD
- SIGN
- S/W CONNECTION
- FOOTPATH
- SIDE ENTRY PIT
- COMMON SERVICE TRENCH
- - - DOMESTIC
- SEWER IO
- DW PROPOSED DOUBLE DRIVEWAY

IMPORTANT
 SERVICE AND DRIVEWAY LOCATIONS
 ARE APPROXIMATE. ANY CHANGES WILL
 BE AT THE PURCHASERS EXPENSE.
 PURCHASER: _____
 DATE: _____

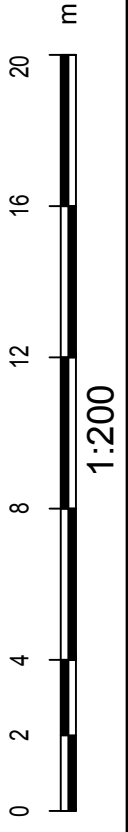

ALLOTMENT 904 in DEV. NO.292/D066/2012
 in the area named
 MUNNO PARA WEST
 CT ---/----

PRELIMINARY

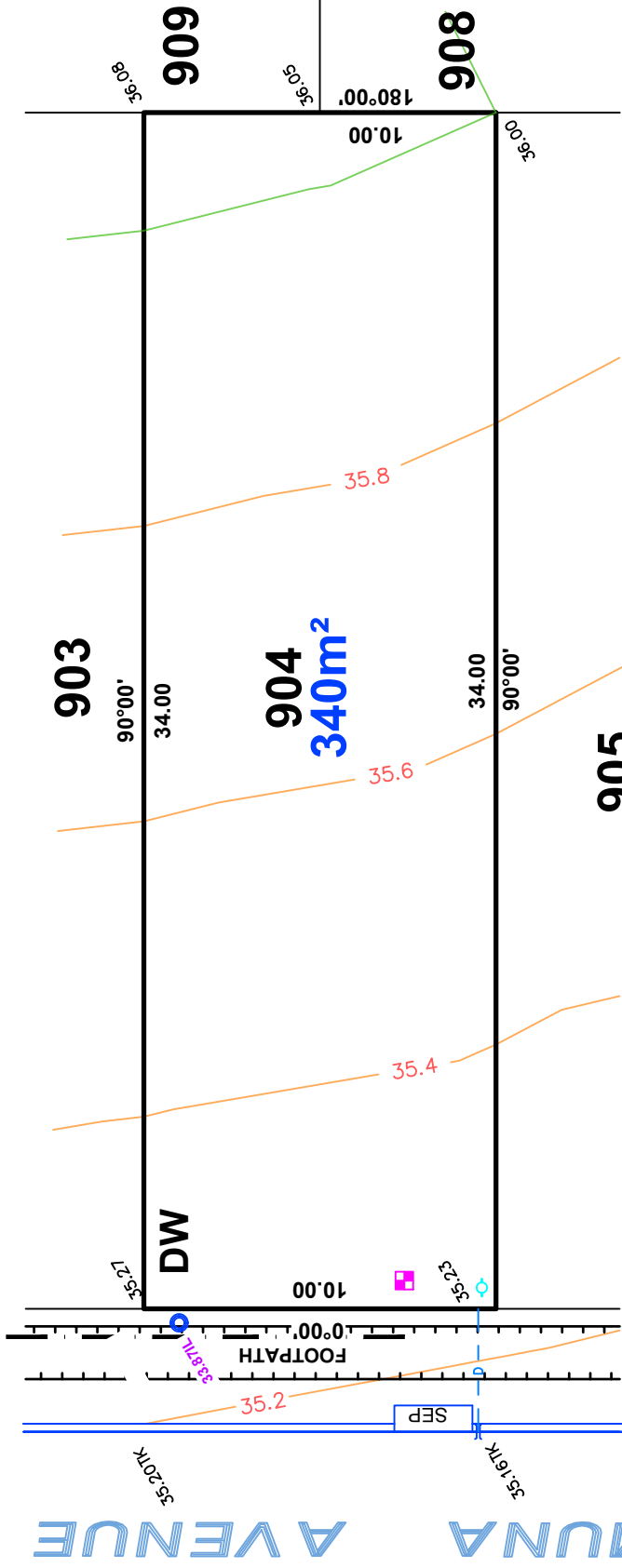
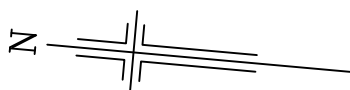

LEGEND

- WATER METER
- SIP SEWER IP
- ▭ STOBIE POLE
- ▭ TELSTRA PIT
- ▭ S/W GRATING
- SEWER MAN HOLE
- ▭ S/W MANHOLE
- ★ LIGHT POLE
- ▭ ETSA CONNECTION
- ⊙ BOLLARD
- ♀ SIGN
- S/W CONNECTION
- FOOTPATH
- ▭ SIDE ENTRY PIT
- COMMON SERVICE TRENCH
- - - DOMESTIC
- SEWER IO
- DW PROPOSED DOUBLE DRIVEWAY

IMPORTANT
 SERVICE AND DRIVEWAY LOCATIONS
 ARE APPROXIMATE. ANY CHANGES WILL
 BE AT THE PURCHASERS EXPENSE.
 PURCHASER: _____
 DATE: _____

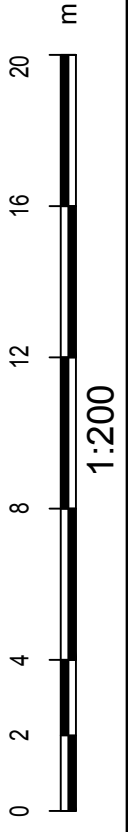

YAMUNA AVENUE

ALLOTMENT 905 in DEV. NO.292/D066/2012
 in the area named
 MUNNO PARA WEST
 CT ---/-----

PRELIMINARY

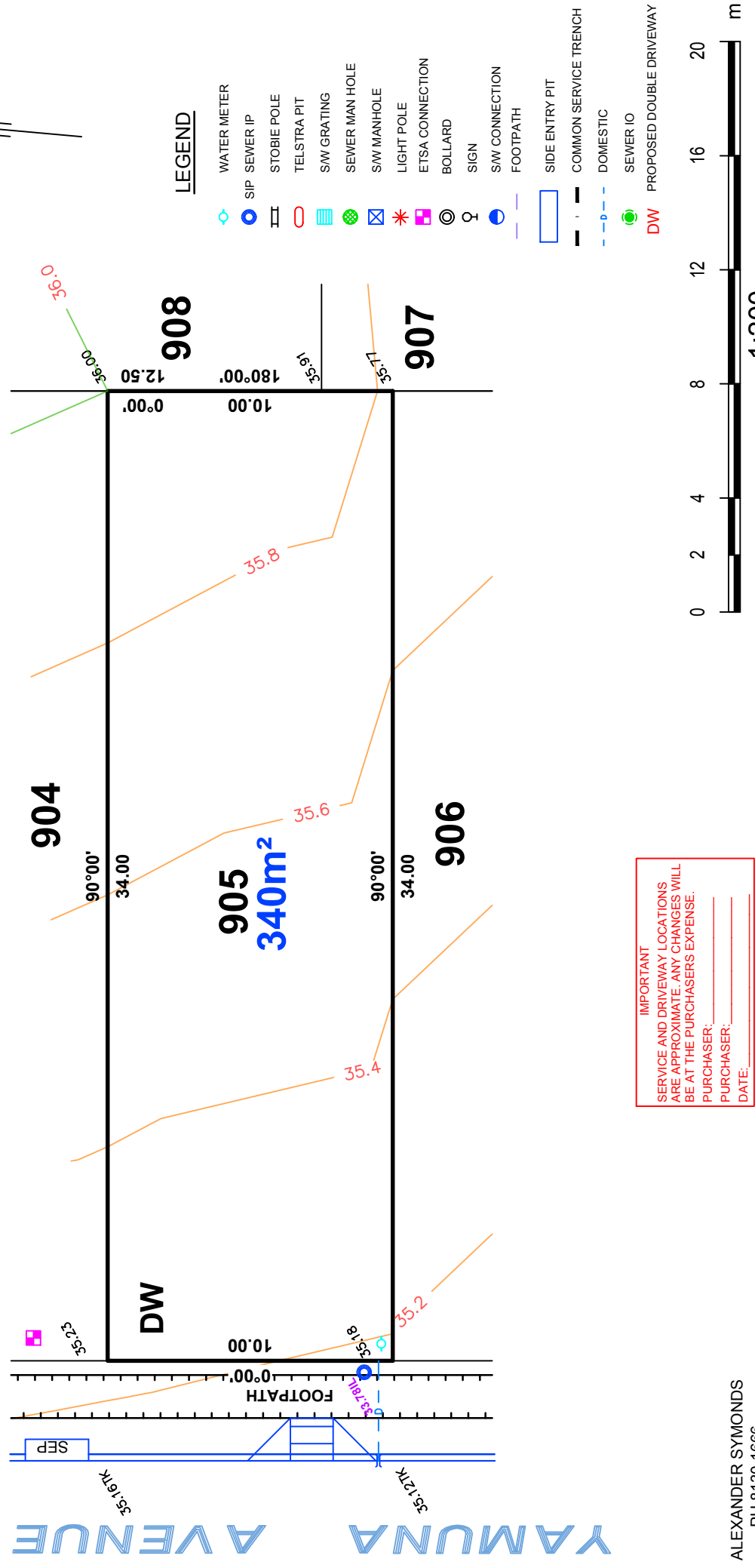
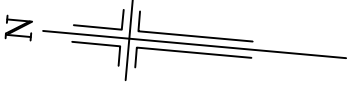

LEGEND

- WATER METER
- SIP
- STOBIE POLE
- TELSTRA PIT
- ▨ S/W GRATING
- SEWER MAN HOLE
- S/W MANHOLE
- ★ LIGHT POLE
- ETSA CONNECTION
- BOLLARD
- ♀ SIGN
- S/W CONNECTION
- FOOTPATH
- SIDE ENTRY PIT
- COMMON SERVICE TRENCH
- - - DOMESTIC
- SEWER IO
- DW PROPOSED DOUBLE DRIVEWAY

IMPORTANT
 SERVICE AND DRIVEWAY LOCATIONS
 ARE APPROXIMATE. ANY CHANGES WILL
 BE AT THE PURCHASERS EXPENSE.
 PURCHASER: _____
 DATE: _____

ALLOTMENT 906 in DEV. NO.292/D066/2012
 in the area named
 MUNNO PARA WEST
 CT ---/-----

PRELIMINARY

905

907

906
455m²

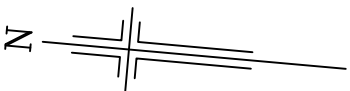
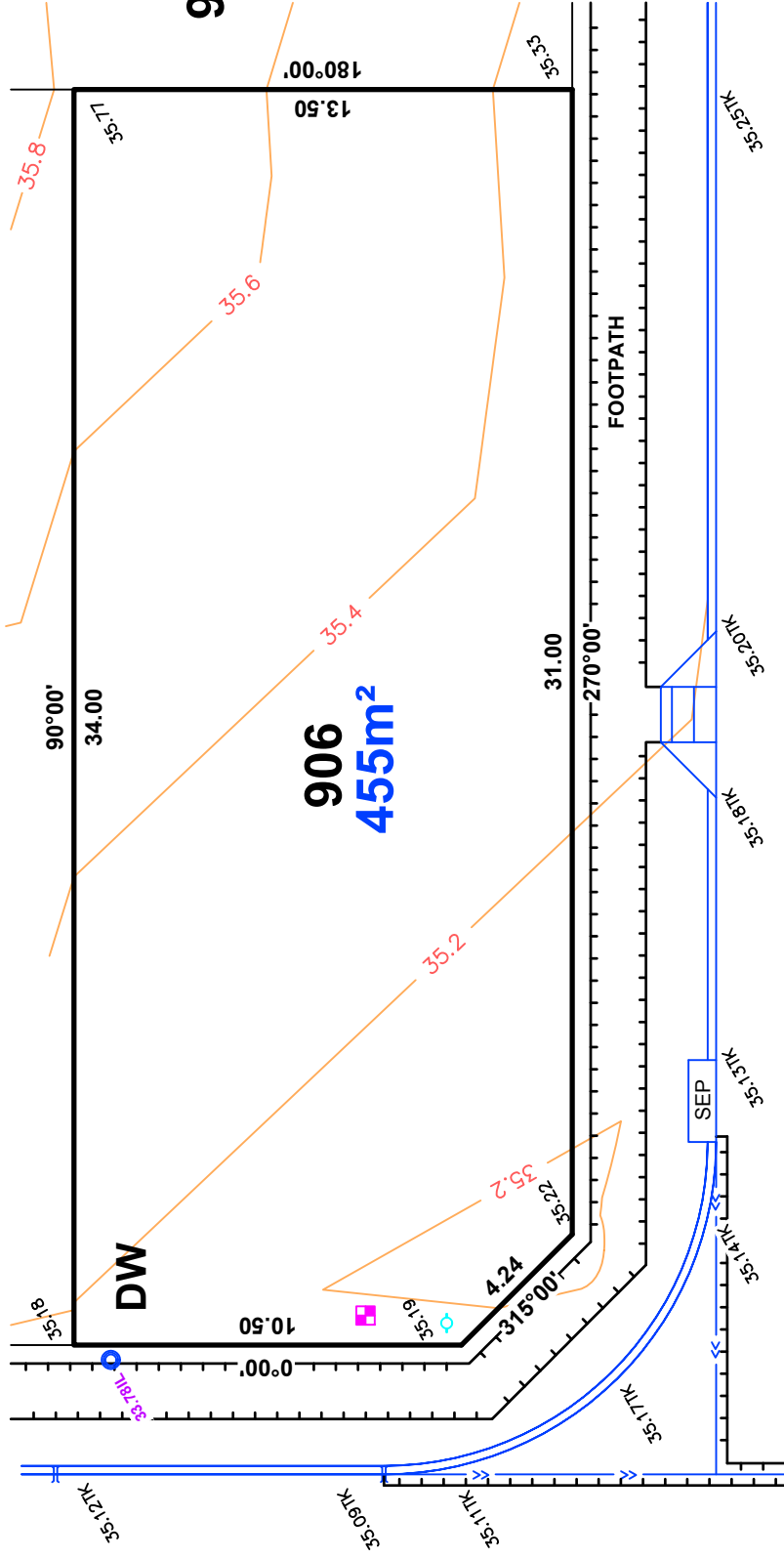

LEGEND

- WATER METER
- SIP
- SEWER IP
- STOBIE POLE
- TELSTRA PIT
- ▨ S/W GRATING
- SEWER MAN HOLE
- S/W MANHOLE
- ★ LIGHT POLE
- ETSA CONNECTION
- BOLLARD
- SIGN
- S/W CONNECTION
- FOOTPATH
- SIDE ENTRY PIT
- COMMON SERVICE TRENCH
- - - DOMESTIC
- SEWER IO
- DW PROPOSED DOUBLE DRIVEWAY

IMPORTANT
 SERVICE AND DRIVEWAY LOCATIONS
 ARE APPROXIMATE. ANY CHANGES WILL
 BE AT THE PURCHASERS EXPENSE.
 PURCHASER: _____
 DATE: _____

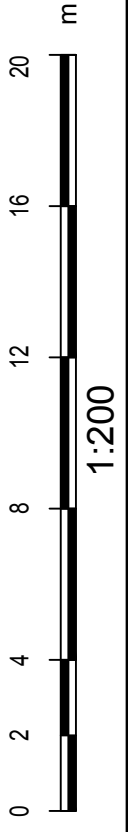

YAMUNA AVENUE

MURCIA AVENUE