



Acacia 1 contour plans

 **AlmondGrove**
MUNNO PARA



IMPORTANT
 SERVICE AND DRIVEWAY LOCATIONS
 ARE APPROXIMATE. ANY CHANGES WILL
 BE AT THE PURCHASERS EXPENSE.
 PURCHASER: _____
 PURCHASER: _____
 DATE: _____

DISCLAIMER:

PLEASE NOTE THAT THIS SITE PLAN IS INTENDED FOR
 VISUAL PURPOSES ONLY. ADDITIONAL SURVEY WORK
 WILL BE REQUIRED PRIOR TO COMMENCING ANY
 DESIGN OR CONSTRUCTION ON SITE.

ALLOTMENT 626 in DEV. NO. 292/D066/12/010

in the area named
ALMOND GROVE

CT ---/----

PRELIMINARY

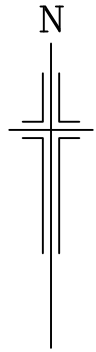

DULCIS CIRCUT

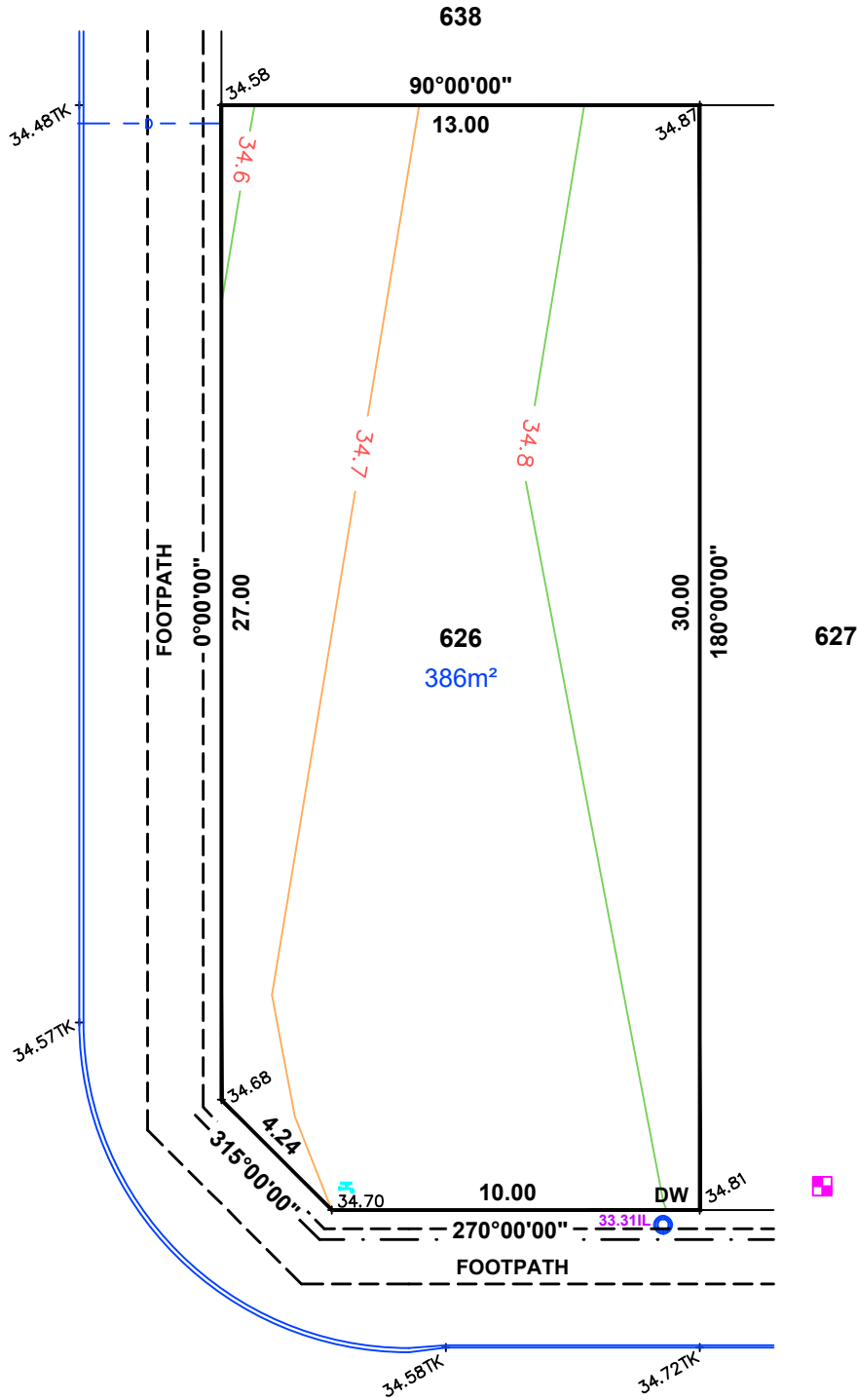

LEGEND

- WATER METER
- SEWER IP
- STOBIE POLE
- TELSTRA PIT
- S/W GRATING
- SEWER MAN HOLE
- S/W MAN HOLE
- LIGHT POLE
- ETSA CONNECTION
- TAP
- BOLLARD
- SIGN
- S/W CONNECTION
- FOOTPATH
- SIDE ENTRY PIT
- COMMON SERVICE TRENCH
- DOMESTIC
- SEWER IO
- POTABLE WATER CONN
- NON-POTABLE WATER CONN
- INVERT LEVEL
- TOP OF RETAINING WALL
- PROPOSE DRIVEWAY

NOTE:
 DRIVEWAY IN PAVERS
 BY DEVELOPER



ALEXANDER SYMONDS
 PH 8130 1666

IMPORTANT
 SERVICE AND DRIVEWAY LOCATIONS
 ARE APPROXIMATE. ANY CHANGES WILL
 BE AT THE PURCHASERS EXPENSE.
 PURCHASER: _____
 PURCHASER: _____
 DATE: _____

DISCLAIMER:

PLEASE NOTE THAT THIS SITE PLAN IS INTENDED FOR
 VISUAL PURPOSES ONLY. ADDITIONAL SURVEY WORK
 WILL BE REQUIRED PRIOR TO COMMENCING ANY
 DESIGN OR CONSTRUCTION ON SITE.

ALLOTMENT 627 in DEV. NO. 292/D066/12/010

in the area named
ALMOND GROVE

CT ---/----

PRELIMINARY

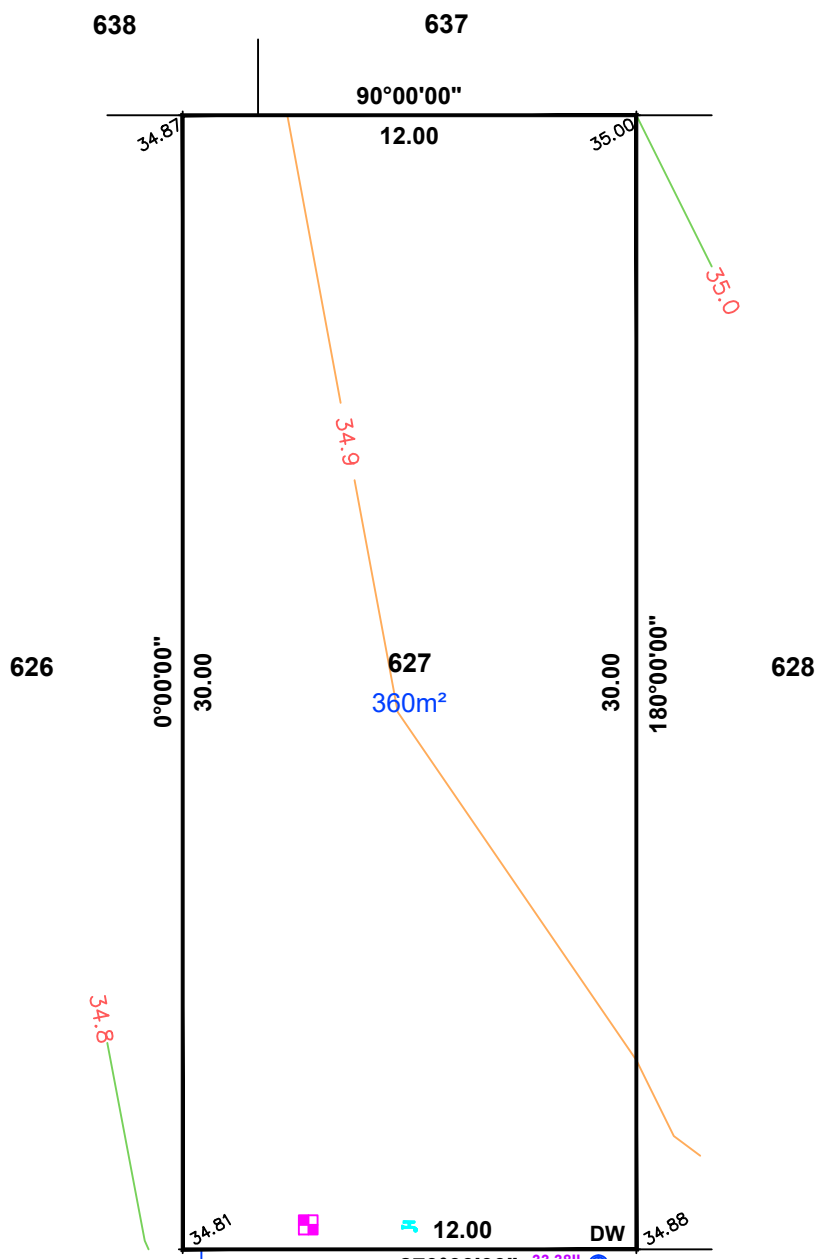
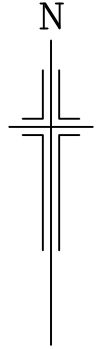

LEGEND

- WATER METER
- SEWER IP
- STOBIE POLE
- TELSTRA PIT
- S/W GRATING
- SEWER MAN HOLE
- S/W MANHOLE
- LIGHT POLE
- ETSA CONNECTION
- TAP
- BOLLARD
- SIGN
- S/W CONNECTION
- FOOTPATH
- SIDE ENTRY PIT
- COMMON SERVICE TRENCH
- DOMESTIC
- SEWER IO
- POTABLE WATER CONN
- NON-POTABLE WATER CONN
- INVERT LEVEL
- TOP OF RETAINING WALL
- PROPOSE DRIVEWAY

LAIT COURT

NOTE:
 DRIVEWAY IN PAVERS
 BY DEVELOPER



ALEXANDER SYMONDS
 PH 8130 1666

ORIGINAL SHEET SIZE A4

IMPORTANT
 SERVICE AND DRIVEWAY LOCATIONS
 ARE APPROXIMATE. ANY CHANGES WILL
 BE AT THE PURCHASERS EXPENSE.
 PURCHASER: _____
 PURCHASER: _____
 DATE: _____

DISCLAIMER:

PLEASE NOTE THAT THIS SITE PLAN IS INTENDED FOR
 VISUAL PURPOSES ONLY. ADDITIONAL SURVEY WORK
 WILL BE REQUIRED PRIOR TO COMMENCING ANY
 DESIGN OR CONSTRUCTION ON SITE.

ALLOTMENT 628 in DEV. NO. 292/D066/12/010

in the area named
ALMOND GROVE

CT ---/----

PRELIMINARY

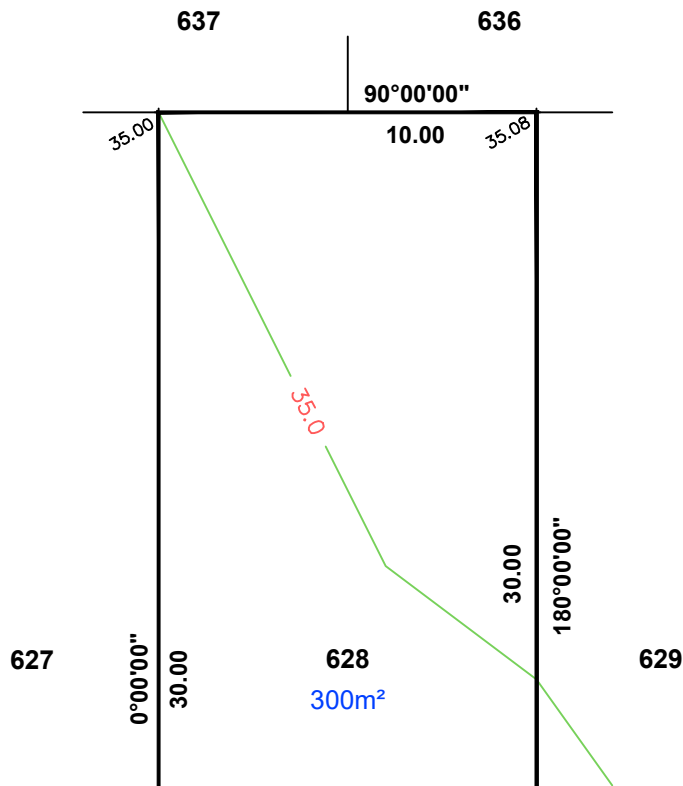
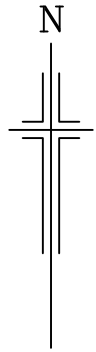

LEGEND

- WATER METER
- SEWER IP
- STOBIE POLE
- TELSTRA PIT
- S/W GRATING
- SEWER MAN HOLE
- S/W MANHOLE
- LIGHT POLE
- ETSA CONNECTION
- TAP
- BOLLARD
- SIGN
- S/W CONNECTION
- FOOTPATH
- SIDE ENTRY PIT
- COMMON SERVICE TRENCH
- DOMESTIC
- SEWER IO
- POTABLE WATER CONN
- NON-POTABLE WATER CONN
- INVERT LEVEL
- TOP OF RETAINING WALL
- PROPOSE DRIVEWAY

LAIT COURT

NOTE:
 DRIVEWAY IN PAVERS
 BY DEVELOPER



ALEXANDER SYMONDS
 PH 8130 1666

IMPORTANT
 SERVICE AND DRIVEWAY LOCATIONS
 ARE APPROXIMATE. ANY CHANGES WILL
 BE AT THE PURCHASERS EXPENSE.
 PURCHASER: _____
 PURCHASER: _____
 DATE: _____

DISCLAIMER:

PLEASE NOTE THAT THIS SITE PLAN IS INTENDED FOR
 VISUAL PURPOSES ONLY. ADDITIONAL SURVEY WORK
 WILL BE REQUIRED PRIOR TO COMMENCING ANY
 DESIGN OR CONSTRUCTION ON SITE.

ALLOTMENT 629 in DEV. NO. 292/D066/12/010

in the area named
ALMOND GROVE

CT ---/----

PRELIMINARY

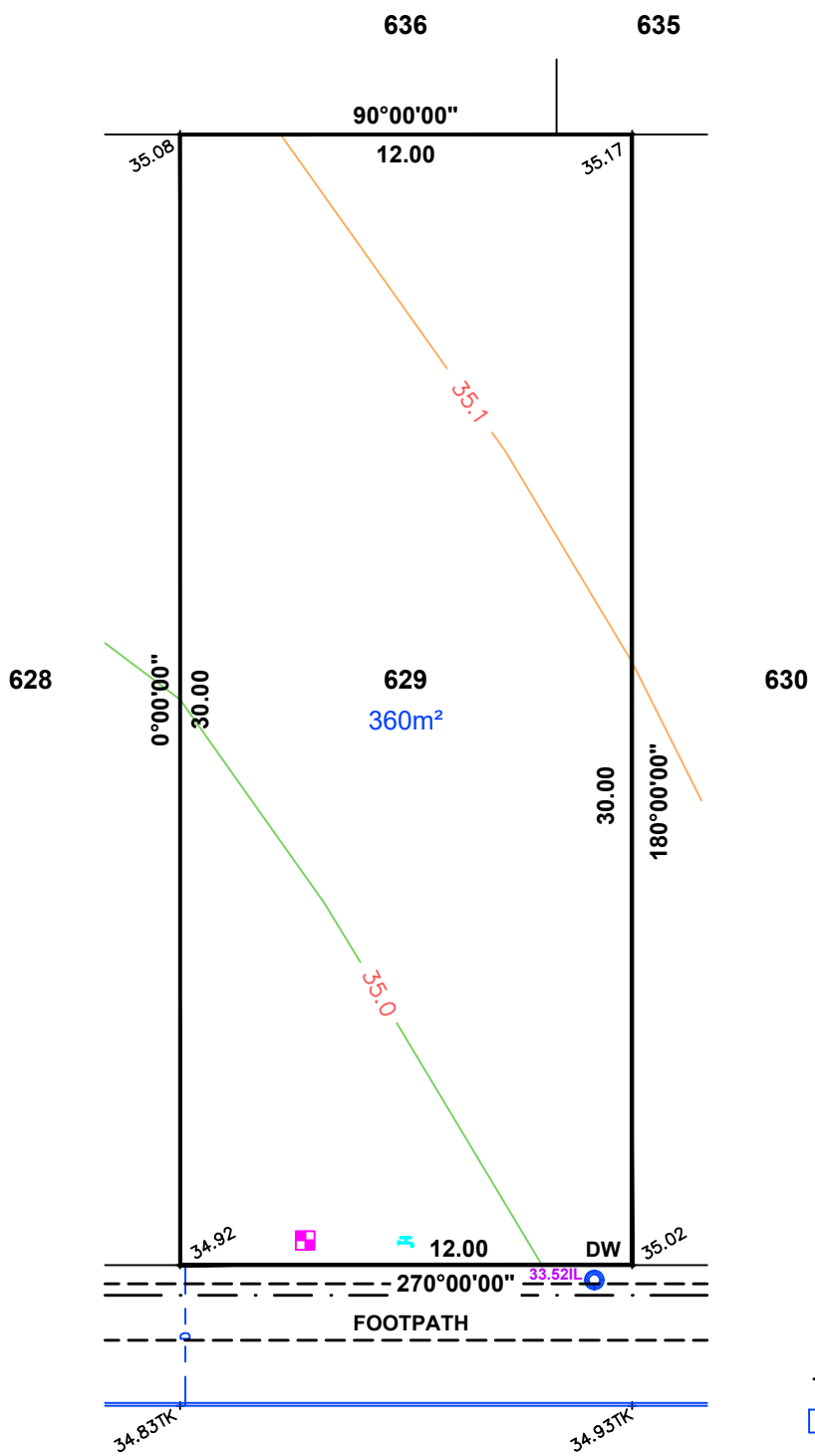
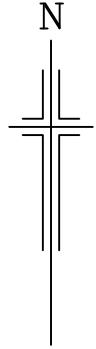

LEGEND

- WATER METER
- SEWER IP
- STOBIE POLE
- TELSTRA PIT
- S/W GRATING
- SEWER MAN HOLE
- S/W MAN HOLE
- LIGHT POLE
- ETSA CONNECTION
- TAP
- BOLLARD
- SIGN
- S/W CONNECTION
- FOOTPATH
- SIDE ENTRY PIT
- COMMON SERVICE TRENCH
- DOMESTIC
- SEWER IO
- POTABLE WATER CONN
- NON-POTABLE WATER CONN
- INVERT LEVEL
- TOP OF RETAINING WALL
- PROPOSE DRIVEWAY

NOTE:
 DRIVEWAY IN PAVERS
 BY DEVELOPER



ALEXANDER SYMONDS
 PH 8130 1666

IMPORTANT
 SERVICE AND DRIVEWAY LOCATIONS
 ARE APPROXIMATE. ANY CHANGES WILL
 BE AT THE PURCHASERS EXPENSE.
 PURCHASER: _____
 PURCHASER: _____
 DATE: _____

DISCLAIMER:
 PLEASE NOTE THAT THIS SITE PLAN IS INTENDED FOR
 VISUAL PURPOSES ONLY. ADDITIONAL SURVEY WORK
 WILL BE REQUIRED PRIOR TO COMMENCING ANY
 DESIGN OR CONSTRUCTION ON SITE.

ALLOTMENT 630 in DEV. NO. 292/D066/12/010
 in the area named
ALMOND GROVE
 CT ---/----

PRELIMINARY

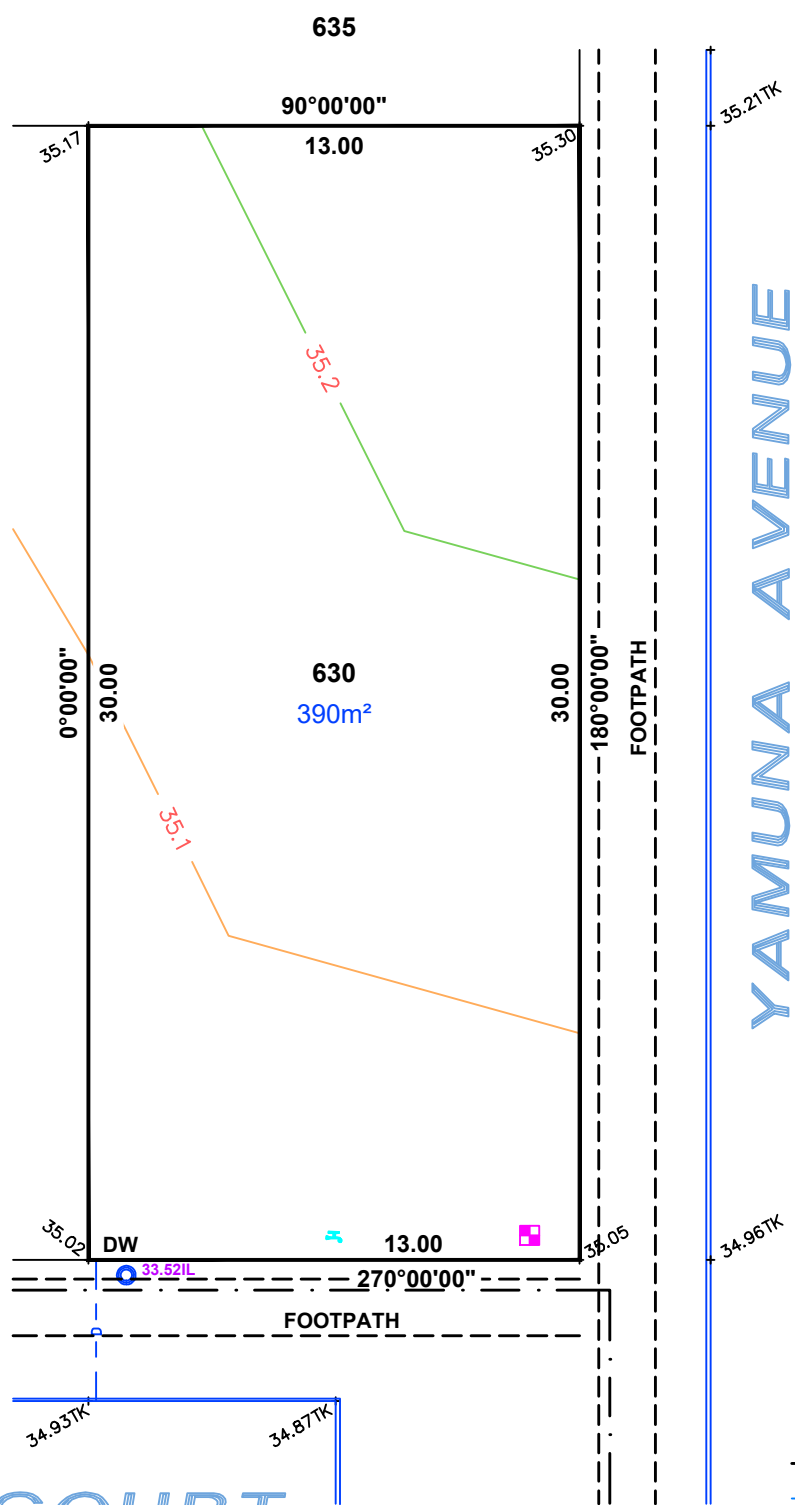
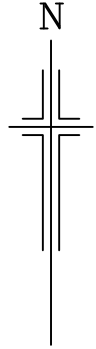

YAMUNA AVENUE

- LEGEND**
- WATER METER
 - SEWER IP
 - STOBIE POLE
 - TELSTRA PIT
 - S/W GRATING
 - SEWER MAN HOLE
 - S/W MAN HOLE
 - LIGHT POLE
 - ETSA CONNECTION
 - TAP
 - BOLLARD
 - SIGN
 - S/W CONNECTION
 - FOOTPATH
 - SIDE ENTRY PIT
 - COMMON SERVICE TRENCH
 - DOMESTIC
 - SEWER IO
 - POTABLE WATER CONN
 - NON-POTABLE WATER CONN
 - INVERT LEVEL
 - TOP OF RETAINING WALL
 - PROPOSE DRIVEWAY

LAIT COURT

NOTE:
 DRIVEWAY IN PAVERS
 BY DEVELOPER



ALEXANDER SYMONDS
 PH 8130 1666

ORIGINAL SHEET SIZE A4

IMPORTANT
 SERVICE AND DRIVEWAY LOCATIONS
 ARE APPROXIMATE. ANY CHANGES WILL
 BE AT THE PURCHASERS EXPENSE.
 PURCHASER: _____
 PURCHASER: _____
 DATE: _____

DISCLAIMER:
 PLEASE NOTE THAT THIS SITE PLAN IS INTENDED FOR
 VISUAL PURPOSES ONLY. ADDITIONAL SURVEY WORK
 WILL BE REQUIRED PRIOR TO COMMENCING ANY
 DESIGN OR CONSTRUCTION ON SITE.

ALLOTMENT 759 in DEV. NO. 292/D066/12/010
 in the area named
ALMOND GROVE
 CT ---/----

PRELIMINARY

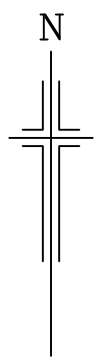

YAMUNA AVENUE

TUONO COURT

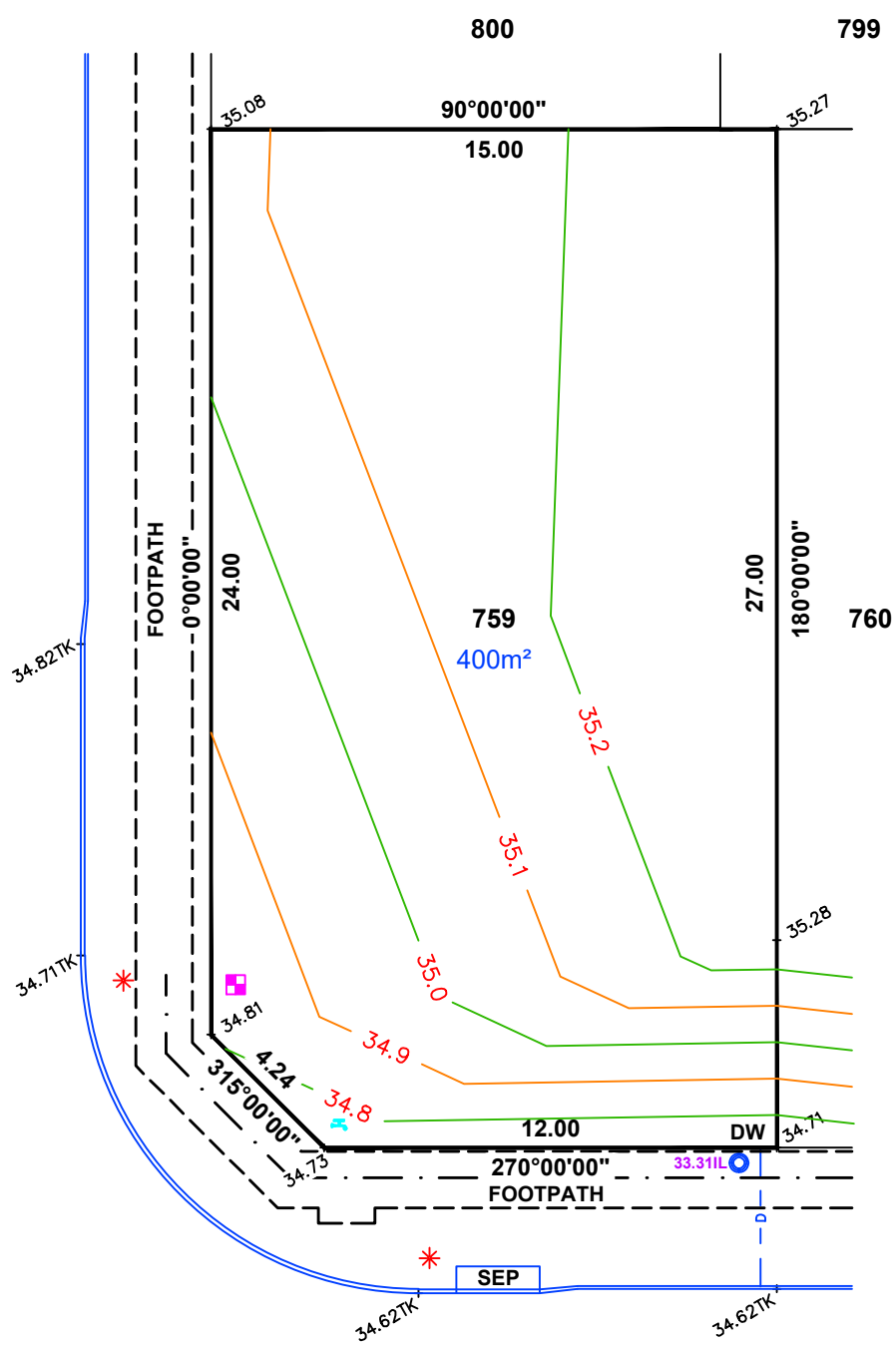

- LEGEND**
- WATER METER
 - SEWER IP
 - STOBIE POLE
 - TELSTRA PIT
 - S/W GRATING
 - SEWER MAN HOLE
 - S/W MANHOLE
 - LIGHT POLE
 - ETSA CONNECTION
 - TAP
 - BOLLARD
 - SIGN
 - S/W CONNECTION
 - FOOTPATH
 - SIDE ENTRY PIT
 - COMMON SERVICE TRENCH
 - DOMESTIC
 - SEWER IO
 - POTABLE WATER CONN
 - NON-POTABLE WATER CONN
 - INVERT LEVEL
 - TOP OF RETAINING WALL
 - PROPOSE DRIVEWAY

NOTE:
 DRIVEWAY IN PAVERS
 BY DEVELOPER



ALEXANDER SYMONDS
 PH 8130 1666

ORIGINAL SHEET SIZE A4

IMPORTANT
 SERVICE AND DRIVEWAY LOCATIONS
 ARE APPROXIMATE. ANY CHANGES WILL
 BE AT THE PURCHASERS EXPENSE.
 PURCHASER: _____
 PURCHASER: _____
 DATE: _____

DISCLAIMER:

PLEASE NOTE THAT THIS SITE PLAN IS INTENDED FOR
 VISUAL PURPOSES ONLY. ADDITIONAL SURVEY WORK
 WILL BE REQUIRED PRIOR TO COMMENCING ANY
 DESIGN OR CONSTRUCTION ON SITE.

ALLOTMENT 760 in DEV. NO. 292/D066/12/010

in the area named
ALMOND GROVE

CT ---/----

PRELIMINARY

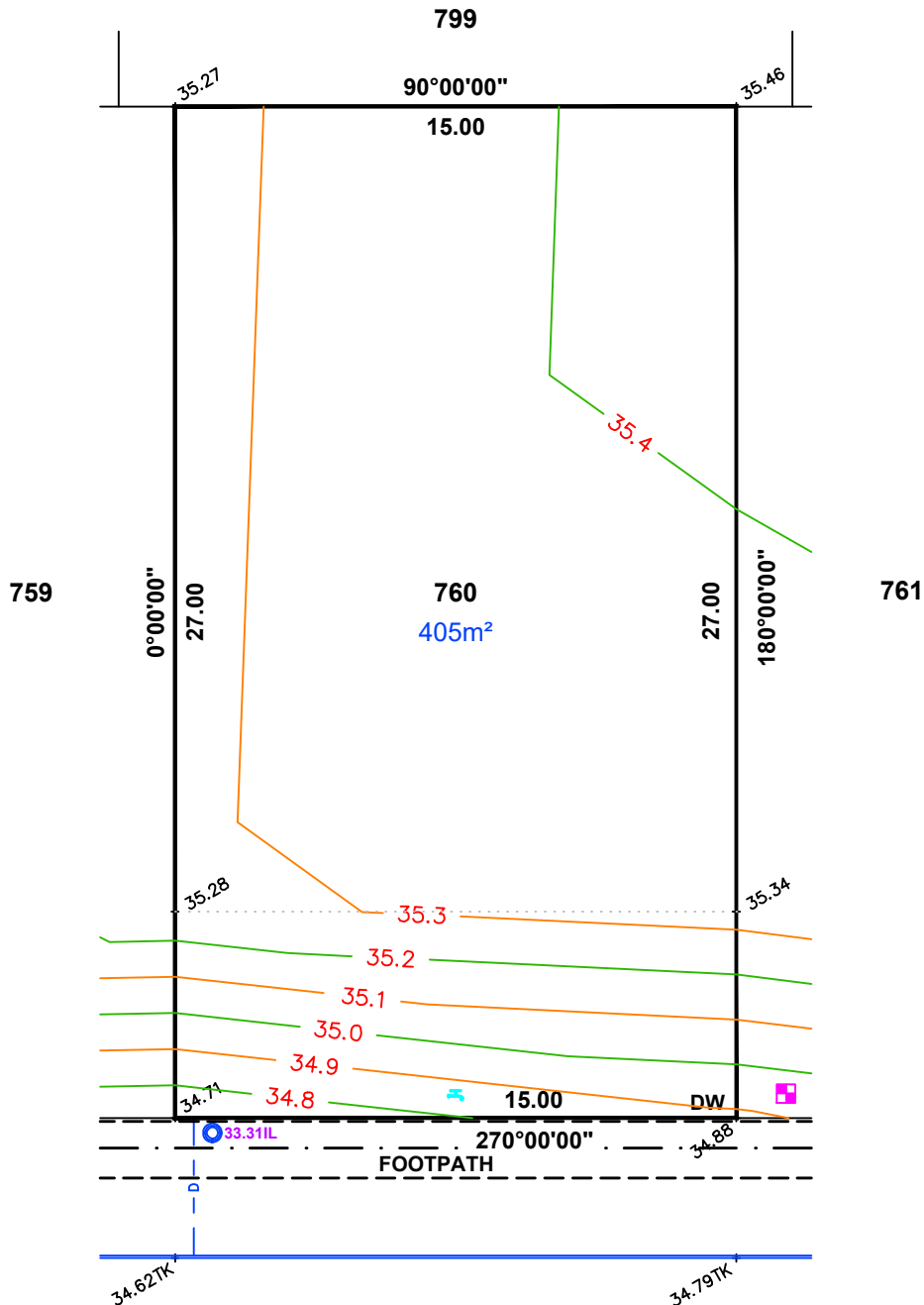
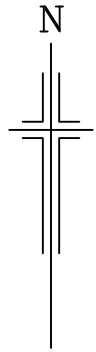

LEGEND

- WATER METER
- SEWER IP
- STOBIE POLE
- TELSTRA PIT
- S/W GRATING
- SEWER MAN HOLE
- S/W MANHOLE
- LIGHT POLE
- ETSA CONNECTION
- TAP
- BOLLARD
- SIGN
- S/W CONNECTION
- FOOTPATH
- SIDE ENTRY PIT
- COMMON SERVICE TRENCH
- DOMESTIC
- SEWER IO
- POTABLE WATER CONN
- NON-POTABLE WATER CONN
- INVERT LEVEL
- TOP OF RETAINING WALL
- PROPOSE DRIVEWAY

TUONO COURT

NOTE:
 DRIVEWAY IN PAVERS
 BY DEVELOPER



ALEXANDER SYMONDS
 PH 8130 1666

ORIGINAL SHEET SIZE A4

IMPORTANT
 SERVICE AND DRIVEWAY LOCATIONS
 ARE APPROXIMATE. ANY CHANGES WILL
 BE AT THE PURCHASERS EXPENSE.
 PURCHASER: _____
 PURCHASER: _____
 DATE: _____

DISCLAIMER:

PLEASE NOTE THAT THIS SITE PLAN IS INTENDED FOR
 VISUAL PURPOSES ONLY. ADDITIONAL SURVEY WORK
 WILL BE REQUIRED PRIOR TO COMMENCING ANY
 DESIGN OR CONSTRUCTION ON SITE.

ALLOTMENT 761 in DEV. NO. 292/D066/12/010

in the area named
ALMOND GROVE

CT ---/----

PRELIMINARY

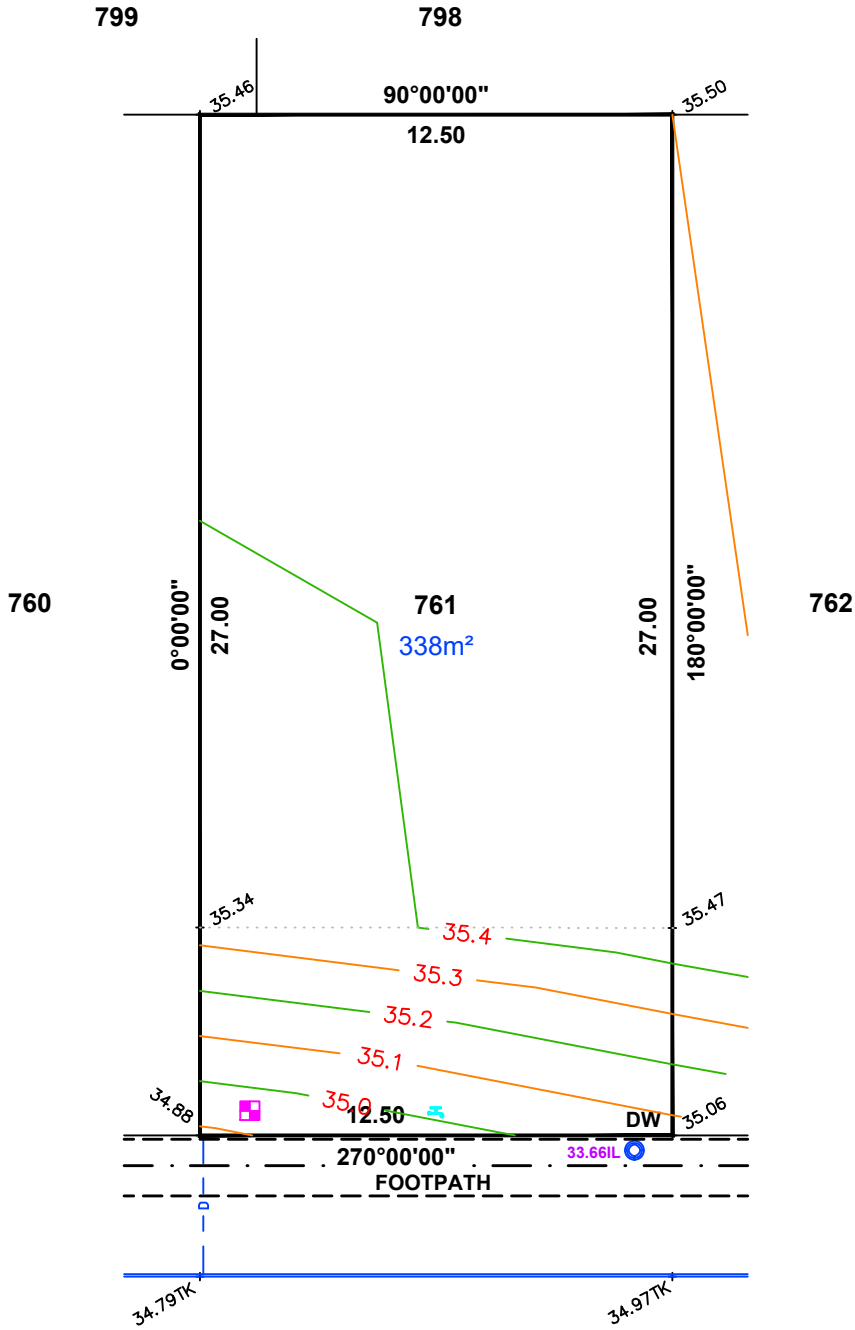
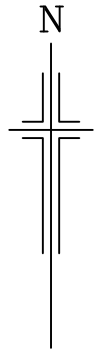

LEGEND

- WATER METER
- SEWER IP
- STOBIE POLE
- TELSTRA PIT
- S/W GRATING
- SEWER MAN HOLE
- S/W MANHOLE
- LIGHT POLE
- ETSA CONNECTION
- TAP
- BOLLARD
- SIGN
- S/W CONNECTION
- FOOTPATH
- SIDE ENTRY PIT
- COMMON SERVICE TRENCH
- DOMESTIC
- SEWER IO
- POTABLE WATER CONN
- NON-POTABLE WATER CONN
- INVERT LEVEL
- TOP OF RETAINING WALL
- PROPOSE DRIVEWAY

TUONO COURT

NOTE:
 DRIVEWAY IN PAVERS
 BY DEVELOPER



ALEXANDER SYMONDS
 PH 8130 1666

ORIGINAL SHEET SIZE A4

IMPORTANT
 SERVICE AND DRIVEWAY LOCATIONS
 ARE APPROXIMATE. ANY CHANGES WILL
 BE AT THE PURCHASERS EXPENSE.
 PURCHASER: _____
 PURCHASER: _____
 DATE: _____

DISCLAIMER:

PLEASE NOTE THAT THIS SITE PLAN IS INTENDED FOR
 VISUAL PURPOSES ONLY. ADDITIONAL SURVEY WORK
 WILL BE REQUIRED PRIOR TO COMMENCING ANY
 DESIGN OR CONSTRUCTION ON SITE.

ALLOTMENT 762 in DEV. NO. 292/D066/12/010

in the area named
ALMOND GROVE

CT ---/----

PRELIMINARY

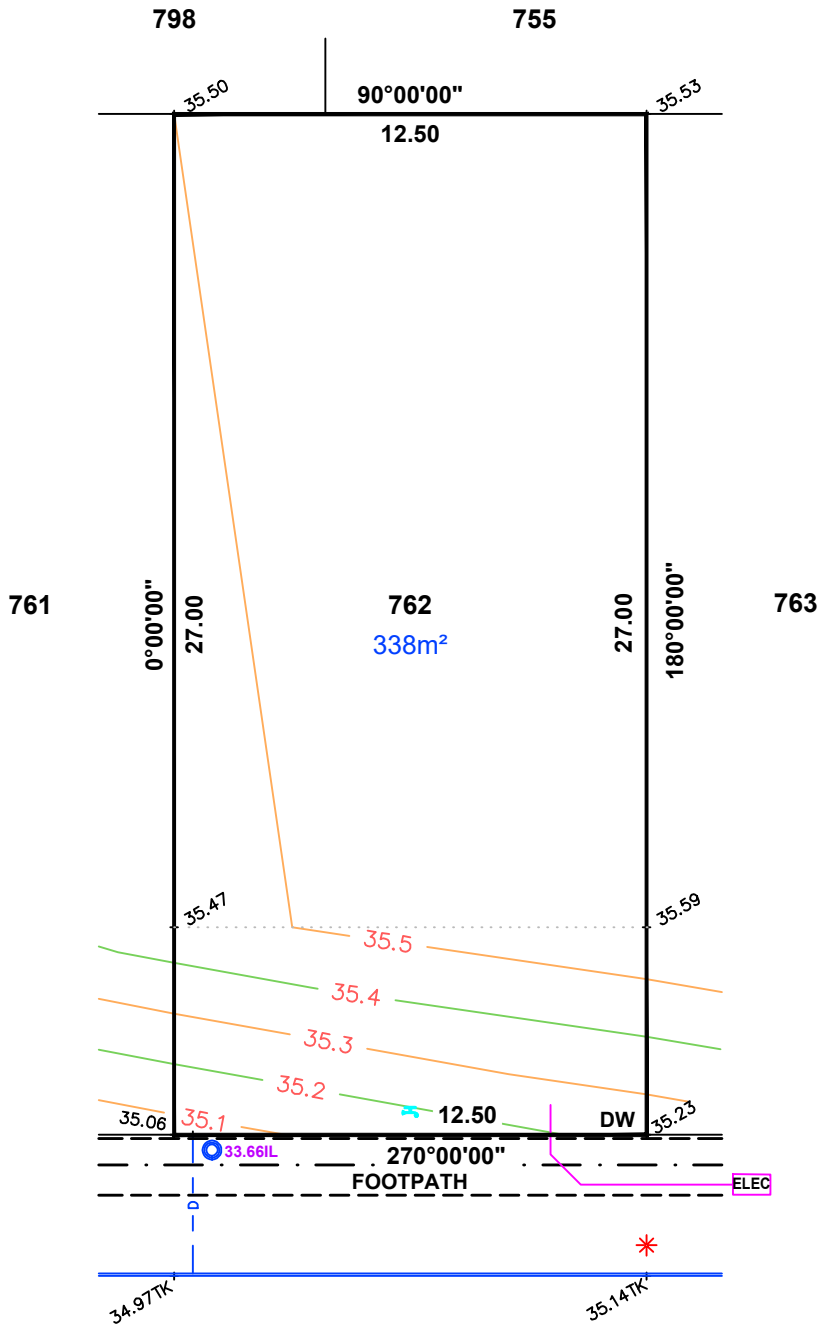
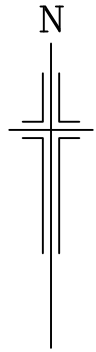

LEGEND

- WATER METER
- SEWER IP
- STOBIE POLE
- TELSTRA PIT
- S/W GRATING
- SEWER MAN HOLE
- S/W MANHOLE
- LIGHT POLE
- ETSA CONNECTION
- TAP
- BOLLARD
- SIGN
- S/W CONNECTION
- FOOTPATH
- SIDE ENTRY PIT
- COMMON SERVICE TRENCH
- DOMESTIC
- SEWER IO
- POTABLE WATER CONN
- NON-POTABLE WATER CONN
- INVERT LEVEL
- TOP OF RETAINING WALL
- PROPOSE DRIVEWAY

TUONO COURT

NOTE:
 DRIVEWAY IN PAVERS
 BY DEVELOPER



ALEXANDER SYMONDS
 PH 8130 1666

ORIGINAL SHEET SIZE A4

IMPORTANT
 SERVICE AND DRIVEWAY LOCATIONS
 ARE APPROXIMATE. ANY CHANGES WILL
 BE AT THE PURCHASERS EXPENSE.
 PURCHASER: _____
 PURCHASER: _____
 DATE: _____

DISCLAIMER:

PLEASE NOTE THAT THIS SITE PLAN IS INTENDED FOR
 VISUAL PURPOSES ONLY. ADDITIONAL SURVEY WORK
 WILL BE REQUIRED PRIOR TO COMMENCING ANY
 DESIGN OR CONSTRUCTION ON SITE.

ALLOTMENT 763 in DEV. NO. 292/D066/12/010

in the area named
ALMOND GROVE

CT ---/----

PRELIMINARY

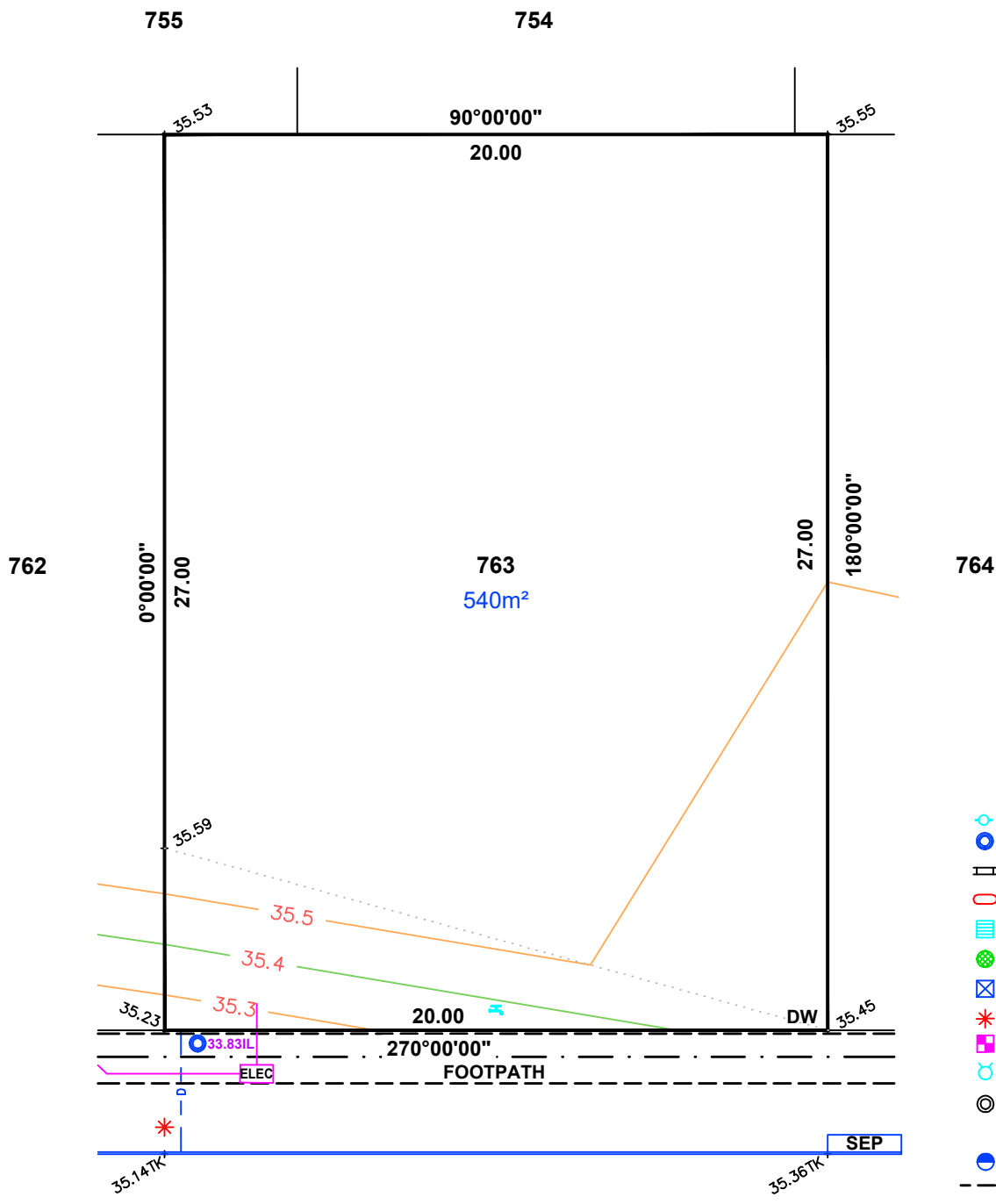
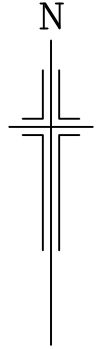

- LEGEND**
- WATER METER
 - SEWER IP
 - STOBIE POLE
 - TELSTRA PIT
 - S/W GRATING
 - SEWER MAN HOLE
 - S/W MANHOLE
 - LIGHT POLE
 - ETSA CONNECTION
 - TAP
 - BOLLARD
 - SIGN
 - S/W CONNECTION
 - FOOTPATH
 - SIDE ENTRY PIT
 - COMMON SERVICE TRENCH
 - DOMESTIC
 - SEWER IO
 - POTABLE WATER CONN
 - NON-POTABLE WATER CONN
 - INVERT LEVEL
 - TOP OF RETAINING WALL
 - PROPOSE DRIVEWAY

TUONO COURT

NOTE:
 DRIVEWAY IN PAVERS
 BY DEVELOPER



ALEXANDER SYMONDS
 PH 8130 1666

IMPORTANT
 SERVICE AND DRIVEWAY LOCATIONS
 ARE APPROXIMATE. ANY CHANGES WILL
 BE AT THE PURCHASERS EXPENSE.
 PURCHASER: _____
 PURCHASER: _____
 DATE: _____

DISCLAIMER:

PLEASE NOTE THAT THIS SITE PLAN IS INTENDED FOR
 VISUAL PURPOSES ONLY. ADDITIONAL SURVEY WORK
 WILL BE REQUIRED PRIOR TO COMMENCING ANY
 DESIGN OR CONSTRUCTION ON SITE.

ALLOTMENT 764 in DEV. NO. 292/D066/12/010

in the area named
ALMOND GROVE

CT ---/----

PRELIMINARY

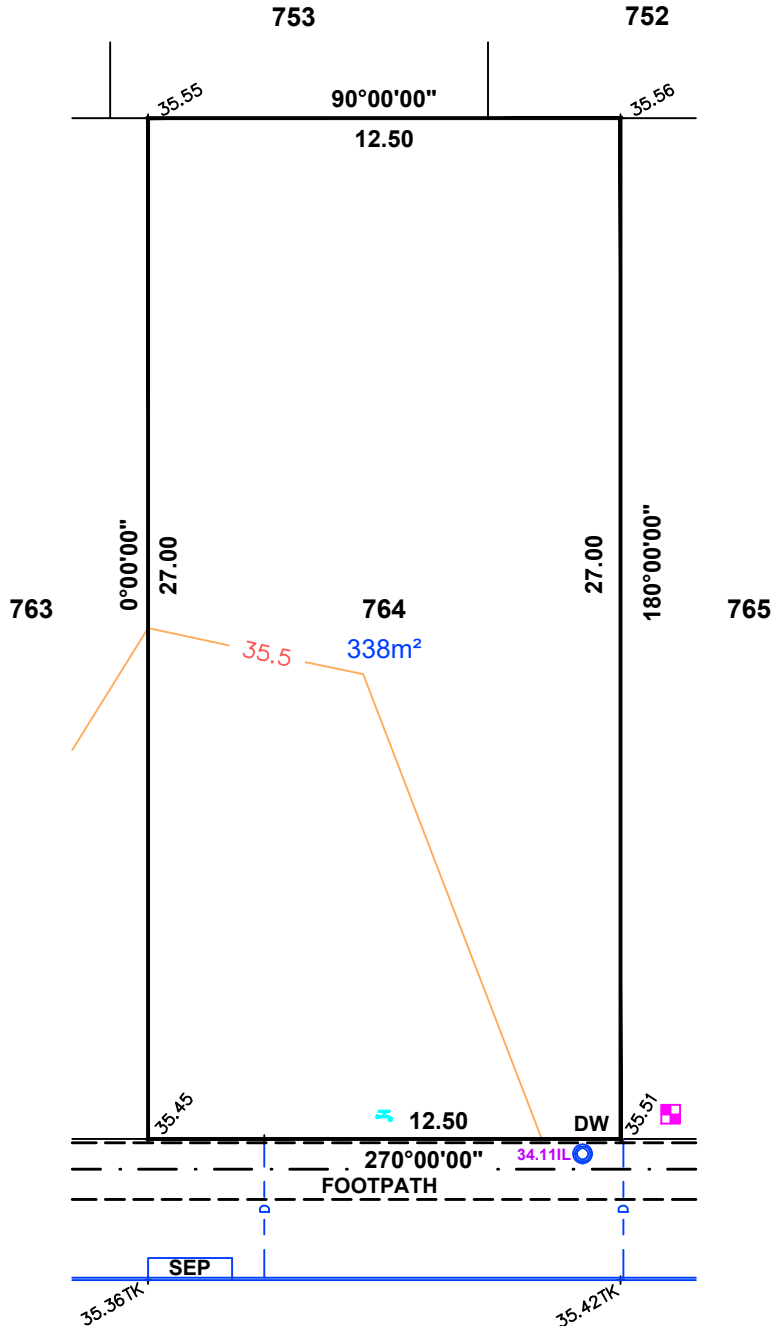
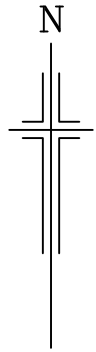

TUONO COURT

LEGEND

- WATER METER
- SEWER IP
- STOBIE POLE
- TELSTRA PIT
- S/W GRATING
- SEWER MAN HOLE
- S/W MANHOLE
- LIGHT POLE
- ETSA CONNECTION
- TAP
- BOLLARD
- SIGN
- S/W CONNECTION
- FOOTPATH
- SIDE ENTRY PIT
- COMMON SERVICE TRENCH
- DOMESTIC
- SEWER IO
- POTABLE WATER CONN
- NON-POTABLE WATER CONN
- INVERT LEVEL
- TOP OF RETAINING WALL
- PROPOSE DRIVEWAY

NOTE:
 DRIVEWAY IN PAVERS
 BY DEVELOPER



1:200

ALEXANDER SYMONDS
 PH 8130 1666

ORIGINAL SHEET SIZE A4

IMPORTANT
 SERVICE AND DRIVEWAY LOCATIONS
 ARE APPROXIMATE. ANY CHANGES WILL
 BE AT THE PURCHASERS EXPENSE.
 PURCHASER: _____
 PURCHASER: _____
 DATE: _____

DISCLAIMER:

PLEASE NOTE THAT THIS SITE PLAN IS INTENDED FOR
 VISUAL PURPOSES ONLY. ADDITIONAL SURVEY WORK
 WILL BE REQUIRED PRIOR TO COMMENCING ANY
 DESIGN OR CONSTRUCTION ON SITE.

ALLOTMENT 765 in DEV. NO. 292/D066/12/010

in the area named
ALMOND GROVE

CT ---/----

PRELIMINARY

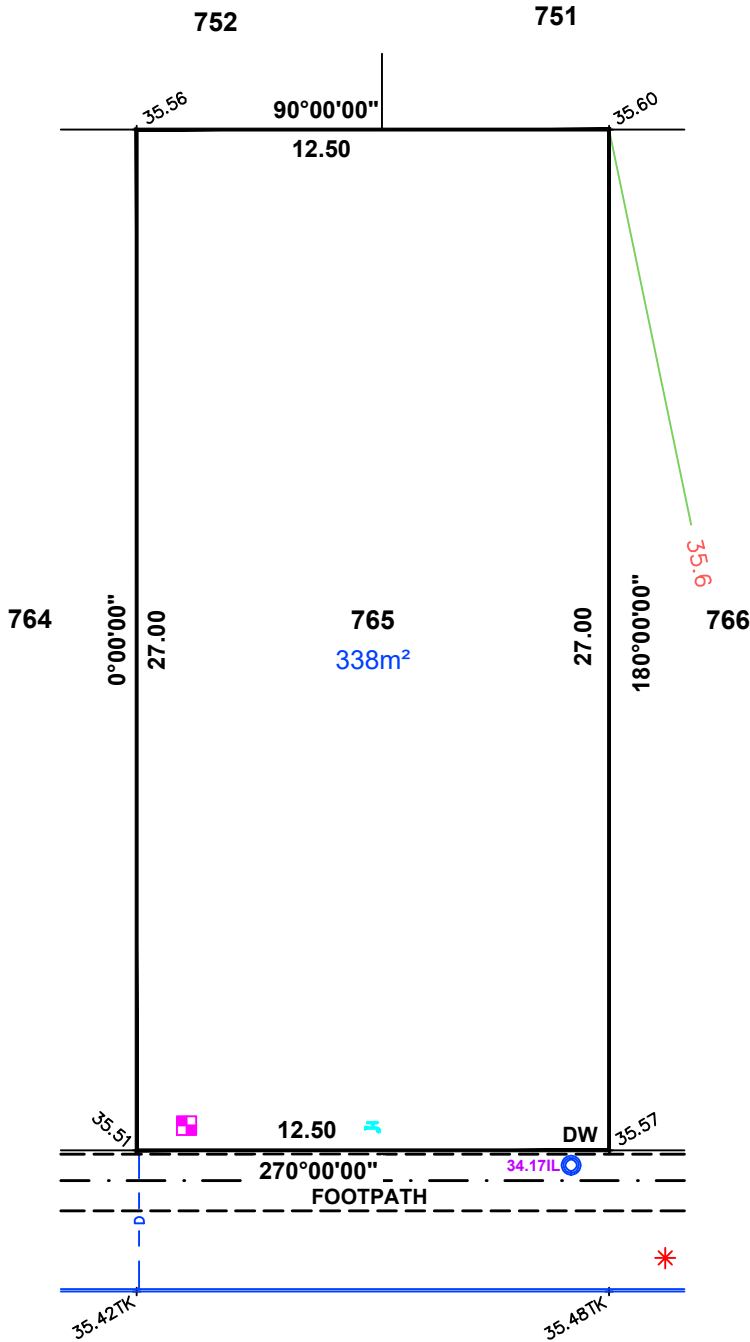
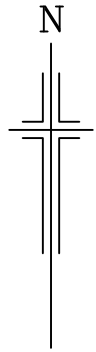

TUONO COURT

LEGEND

- WATER METER
- SEWER IP
- STOBIE POLE
- TELSTRA PIT
- S/W GRATING
- SEWER MAN HOLE
- S/W MANHOLE
- LIGHT POLE
- ETSA CONNECTION
- TAP
- BOLLARD
- SIGN
- S/W CONNECTION
- FOOTPATH
- SIDE ENTRY PIT
- COMMON SERVICE TRENCH
- DOMESTIC
- SEWER IO
- POTABLE WATER CONN
- NON-POTABLE WATER CONN
- INVERT LEVEL
- TOP OF RETAINING WALL
- PROPOSE DRIVEWAY

NOTE:
 DRIVEWAY IN PAVERS
 BY DEVELOPER



1:200

ALEXANDER SYMONDS
 PH 8130 1666

ORIGINAL SHEET SIZE A4

IMPORTANT
 SERVICE AND DRIVEWAY LOCATIONS
 ARE APPROXIMATE. ANY CHANGES WILL
 BE AT THE PURCHASERS EXPENSE.
 PURCHASER: _____
 PURCHASER: _____
 DATE: _____

DISCLAIMER:

PLEASE NOTE THAT THIS SITE PLAN IS INTENDED FOR
 VISUAL PURPOSES ONLY. ADDITIONAL SURVEY WORK
 WILL BE REQUIRED PRIOR TO COMMENCING ANY
 DESIGN OR CONSTRUCTION ON SITE.

ALLOTMENT 766 in DEV. NO. 292/D066/12/010

in the area named
ALMOND GROVE

CT ---/----

PRELIMINARY

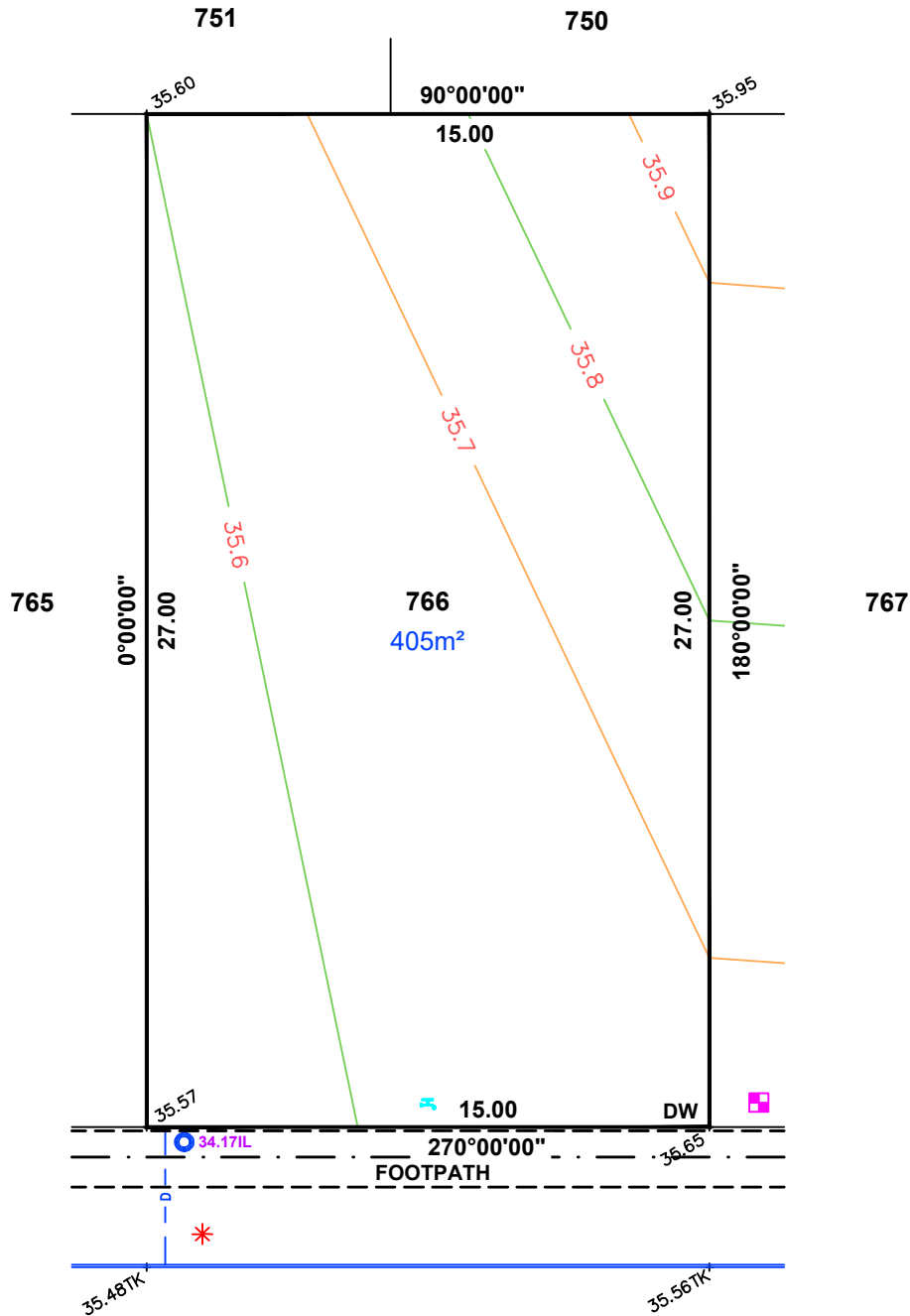
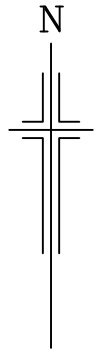

TUONO COURT

LEGEND

- WATER METER
- SEWER IP
- STOBIE POLE
- TELSTRA PIT
- S/W GRATING
- SEWER MAN HOLE
- S/W MANHOLE
- LIGHT POLE
- ETSA CONNECTION
- TAP
- BOLLARD
- SIGN
- S/W CONNECTION
- FOOTPATH
- SIDE ENTRY PIT
- COMMON SERVICE TRENCH
- DOMESTIC
- SEWER IO
- POTABLE WATER CONN
- NON-POTABLE WATER CONN
- INVERT LEVEL
- TOP OF RETAINING WALL
- DW PROPOSE DRIVEWAY

NOTE:
 DRIVEWAY IN PAVERS
 BY DEVELOPER



ALEXANDER SYMONDS
 PH 8130 1666

ORIGINAL SHEET SIZE A4

IMPORTANT
 SERVICE AND DRIVEWAY LOCATIONS
 ARE APPROXIMATE. ANY CHANGES WILL
 BE AT THE PURCHASERS EXPENSE.
 PURCHASER: _____
 PURCHASER: _____
 DATE: _____

DISCLAIMER:

PLEASE NOTE THAT THIS SITE PLAN IS INTENDED FOR
 VISUAL PURPOSES ONLY. ADDITIONAL SURVEY WORK
 WILL BE REQUIRED PRIOR TO COMMENCING ANY
 DESIGN OR CONSTRUCTION ON SITE.

ALLOTMENT 767 in DEV. NO. 292/D066/12/010

in the area named
ALMOND GROVE

CT ---/----

PRELIMINARY

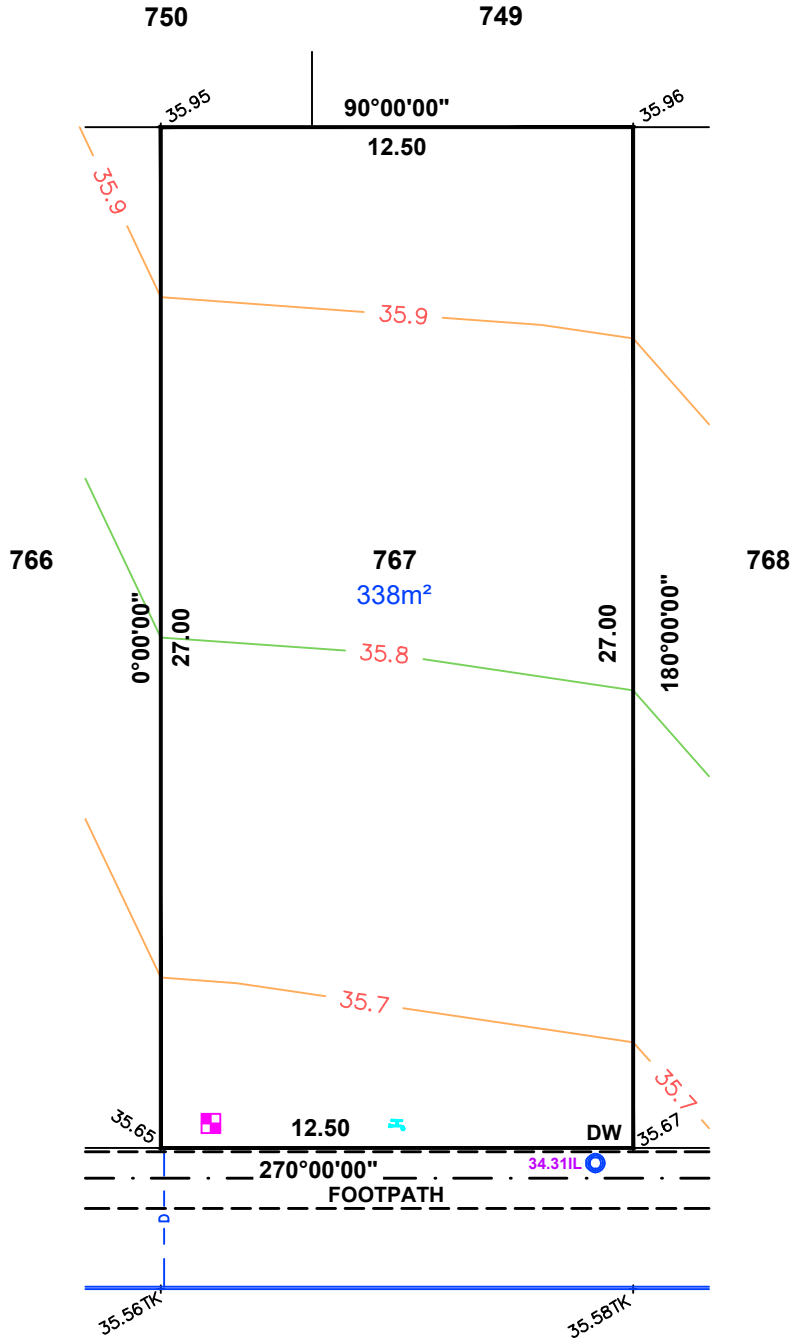
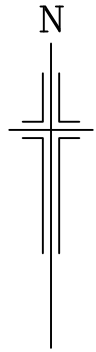

LEGEND

- WATER METER
- SEWER IP
- STOBIE POLE
- TELSTRA PIT
- S/W GRATING
- SEWER MAN HOLE
- S/W MANHOLE
- LIGHT POLE
- ETSA CONNECTION
- TAP
- BOLLARD
- SIGN
- S/W CONNECTION
- FOOTPATH
- SIDE ENTRY PIT
- COMMON SERVICE TRENCH
- DOMESTIC
- SEWER IO
- POTABLE WATER CONN
- NON-POTABLE WATER CONN
- INVERT LEVEL
- TOP OF RETAINING WALL
- PROPOSE DRIVEWAY

TUONO COURT

NOTE:
 DRIVEWAY IN PAVERS
 BY DEVELOPER



ALEXANDER SYMONDS
 PH 8130 1666

ORIGINAL SHEET SIZE A4

IMPORTANT
 SERVICE AND DRIVEWAY LOCATIONS
 ARE APPROXIMATE. ANY CHANGES WILL
 BE AT THE PURCHASERS EXPENSE.
 PURCHASER: _____
 PURCHASER: _____
 DATE: _____

DISCLAIMER:

PLEASE NOTE THAT THIS SITE PLAN IS INTENDED FOR
 VISUAL PURPOSES ONLY. ADDITIONAL SURVEY WORK
 WILL BE REQUIRED PRIOR TO COMMENCING ANY
 DESIGN OR CONSTRUCTION ON SITE.

ALLOTMENT 768 in DEV. NO. 292/D066/12/010

in the area named
ALMOND GROVE

CT ---/----

PRELIMINARY

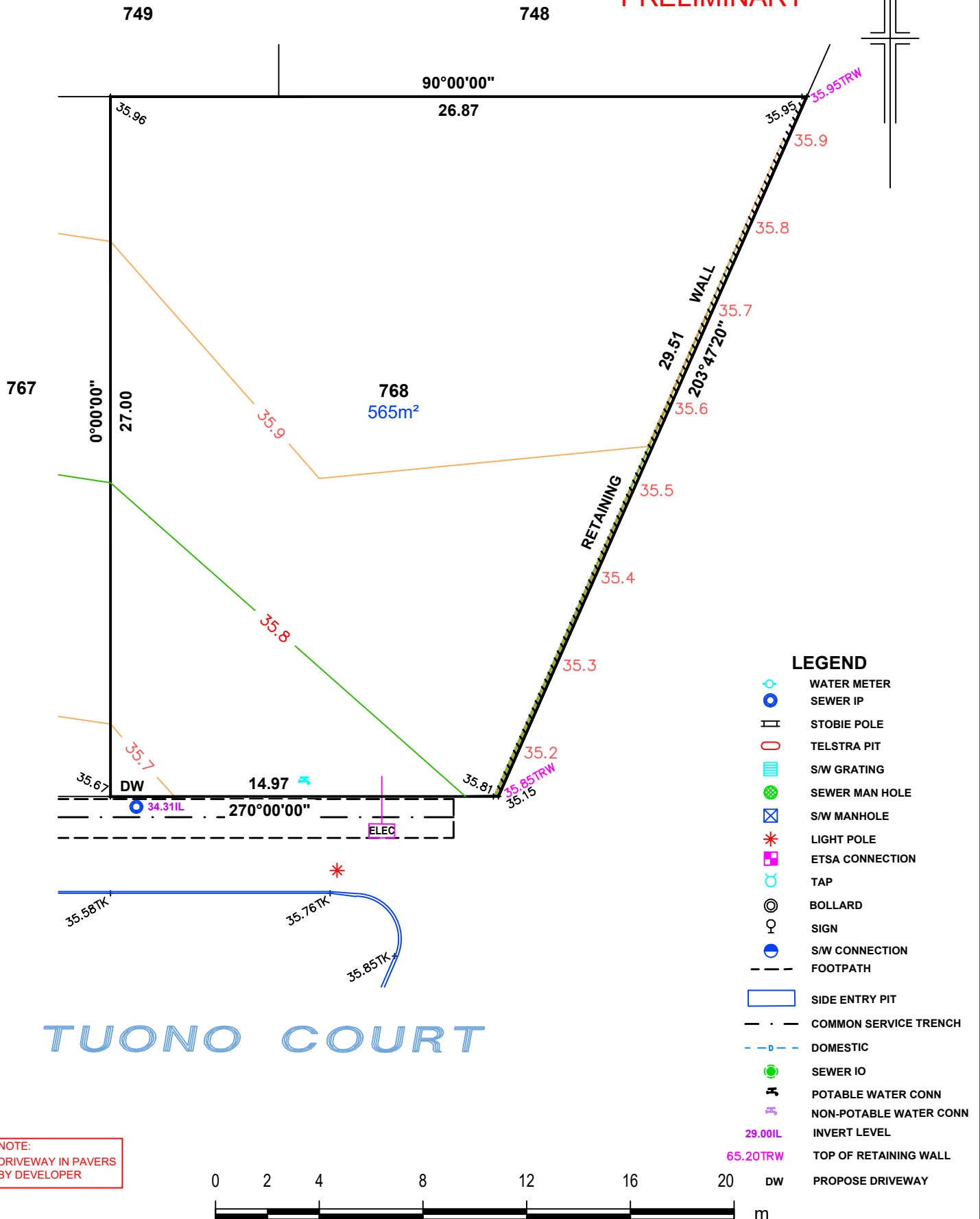
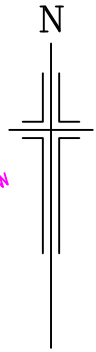

NOTE:
 DRIVEWAY IN PAVERS
 BY DEVELOPER

ALEXANDER SYMONDS
 PH 8130 1666

1:200

ORIGINAL SHEET SIZE A4

IMPORTANT
 SERVICE AND DRIVEWAY LOCATIONS
 ARE APPROXIMATE. ANY CHANGES WILL
 BE AT THE PURCHASERS EXPENSE.
 PURCHASER: _____
 PURCHASER: _____
 DATE: _____

DISCLAIMER:

PLEASE NOTE THAT THIS SITE PLAN IS INTENDED FOR
 VISUAL PURPOSES ONLY. ADDITIONAL SURVEY WORK
 WILL BE REQUIRED PRIOR TO COMMENCING ANY
 DESIGN OR CONSTRUCTION ON SITE.

ALLOTMENT 769 in DEV. NO. 292/D066/12/010

in the area named
ALMOND GROVE

CT ---/----

PRELIMINARY

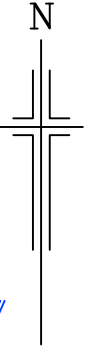

TUONO COURT

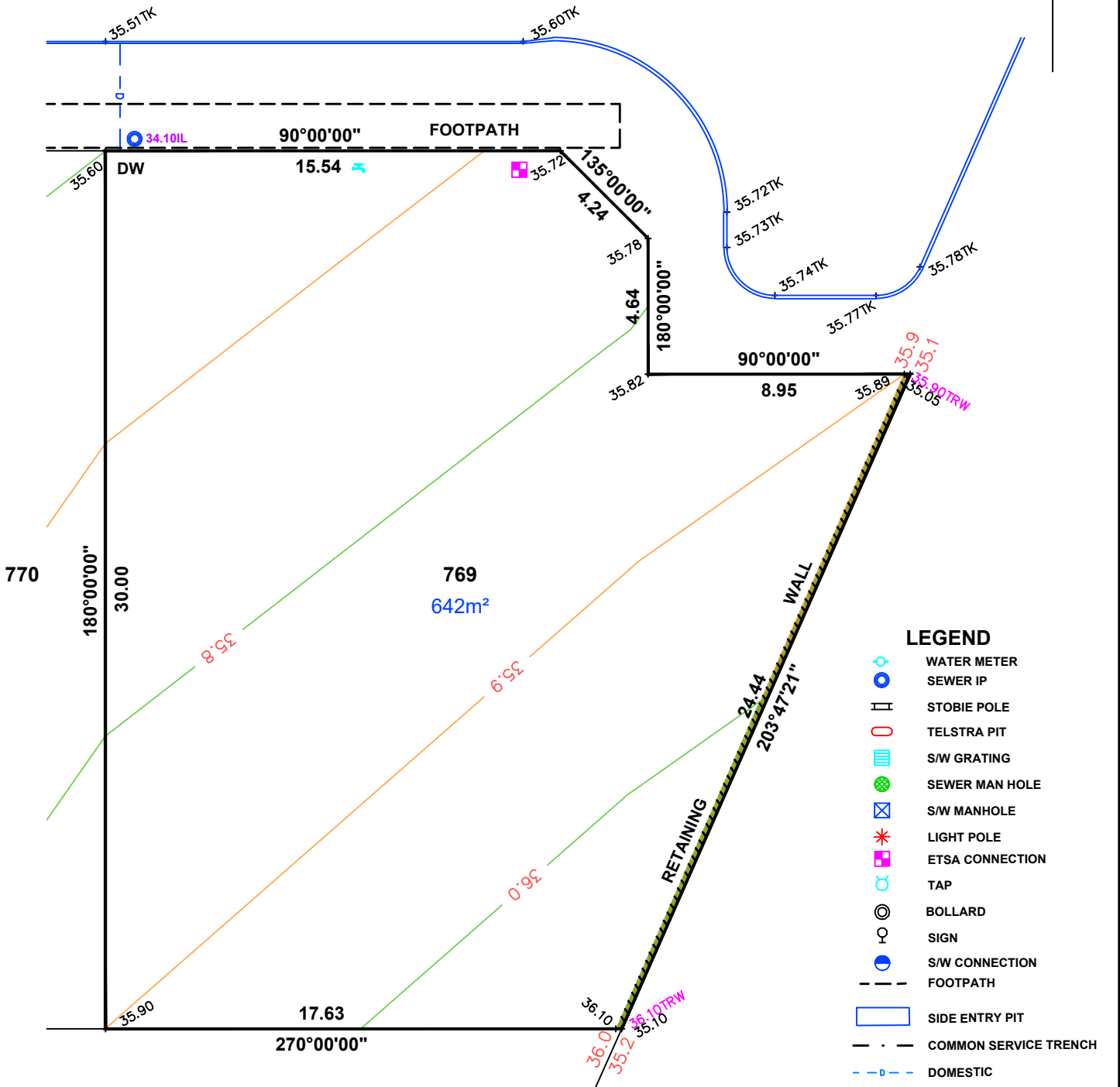

LEGEND

- WATER METER
- SEWER IP
- STOBIE POLE
- TELSTRA PIT
- S/W GRATING
- SEWER MAN HOLE
- S/W MANHOLE
- LIGHT POLE
- ETSA CONNECTION
- TAP
- BOLLARD
- SIGN
- S/W CONNECTION
- FOOTPATH
- SIDE ENTRY PIT
- COMMON SERVICE TRENCH
- DOMESTIC
- SEWER IO
- POTABLE WATER CONN
- NON-POTABLE WATER CONN
- INVERT LEVEL
- TOP OF RETAINING WALL
- PROPOSE DRIVEWAY

NOTE:
 DRIVEWAY IN PAVERS
 BY DEVELOPER



1:200

ALEXANDER SYMONDS
 PH 8130 1666

ORIGINAL SHEET SIZE A4

IMPORTANT
 SERVICE AND DRIVEWAY LOCATIONS
 ARE APPROXIMATE. ANY CHANGES WILL
 BE AT THE PURCHASERS EXPENSE.
 PURCHASER: _____
 PURCHASER: _____
 DATE: _____

DISCLAIMER:

PLEASE NOTE THAT THIS SITE PLAN IS INTENDED FOR
 VISUAL PURPOSES ONLY. ADDITIONAL SURVEY WORK
 WILL BE REQUIRED PRIOR TO COMMENCING ANY
 DESIGN OR CONSTRUCTION ON SITE.

ALLOTMENT 770 in DEV. NO. 292/D066/12/010

in the area named

ALMOND GROVE

CT ---/----

PRELIMINARY

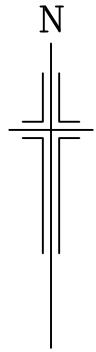

TUONO COURT

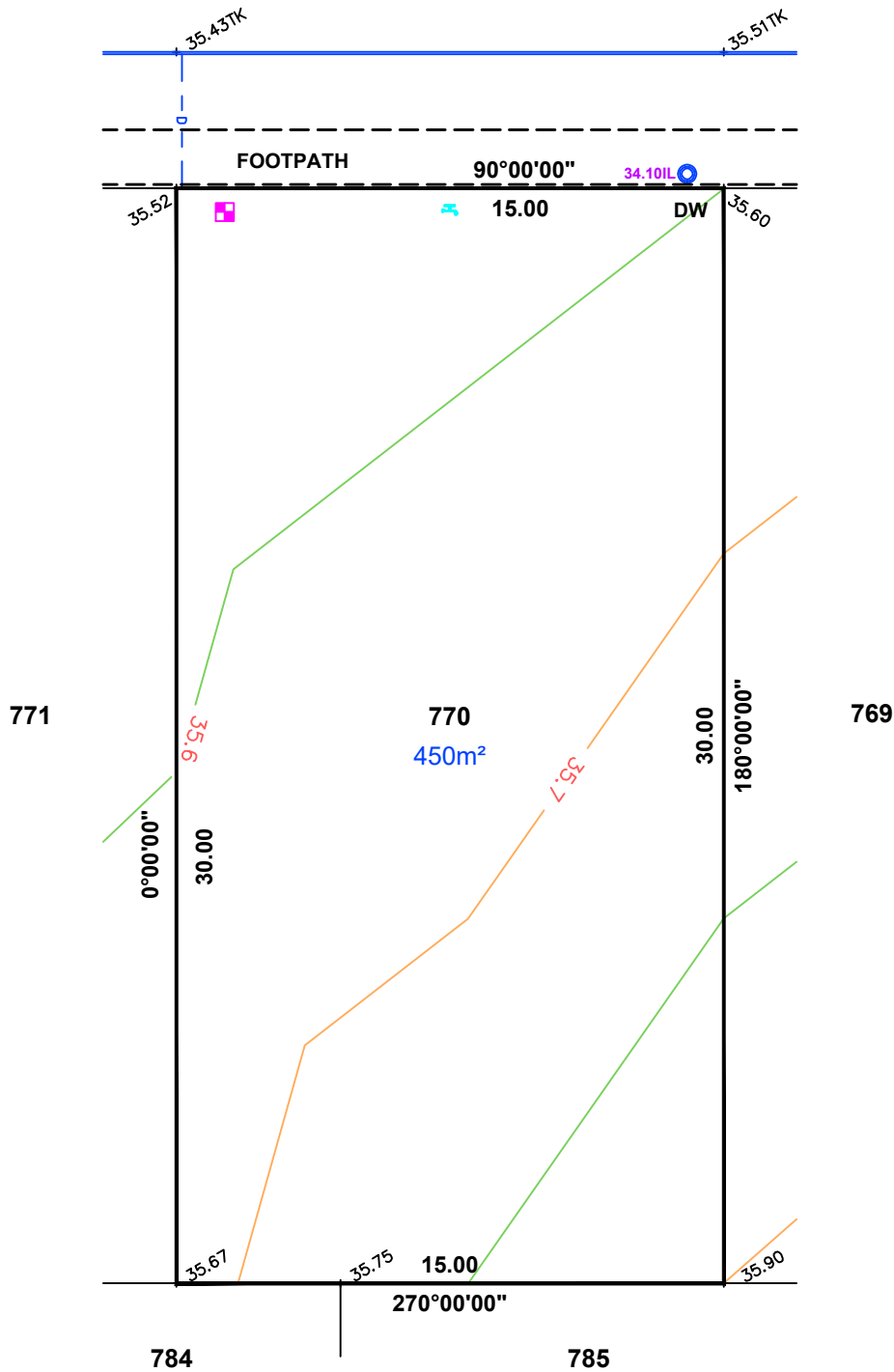

LEGEND

- WATER METER
- SEWER IP
- STOBIE POLE
- TELSTRA PIT
- S/W GRATING
- SEWER MAN HOLE
- S/W MANHOLE
- LIGHT POLE
- ETSA CONNECTION
- TAP
- BOLLARD
- SIGN
- S/W CONNECTION
- FOOTPATH
- SIDE ENTRY PIT
- COMMON SERVICE TRENCH
- DOMESTIC
- SEWER IO
- POTABLE WATER CONN
- NON-POTABLE WATER CONN
- INVERT LEVEL
- TOP OF RETAINING WALL
- PROPOSE DRIVEWAY

NOTE:
 DRIVEWAY IN PAVERS
 BY DEVELOPER



ALEXANDER SYMONDS
 PH 8130 1666

ORIGINAL SHEET SIZE A4

IMPORTANT
 SERVICE AND DRIVEWAY LOCATIONS
 ARE APPROXIMATE. ANY CHANGES WILL
 BE AT THE PURCHASERS EXPENSE.
 PURCHASER: _____
 PURCHASER: _____
 DATE: _____

DISCLAIMER:

PLEASE NOTE THAT THIS SITE PLAN IS INTENDED FOR
 VISUAL PURPOSES ONLY. ADDITIONAL SURVEY WORK
 WILL BE REQUIRED PRIOR TO COMMENCING ANY
 DESIGN OR CONSTRUCTION ON SITE.

ALLOTMENT 771 in DEV. NO. 292/D066/12/010

in the area named
ALMOND GROVE

CT ---/----

PRELIMINARY

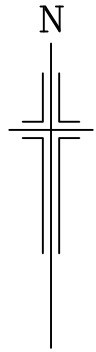

TUONO COURT

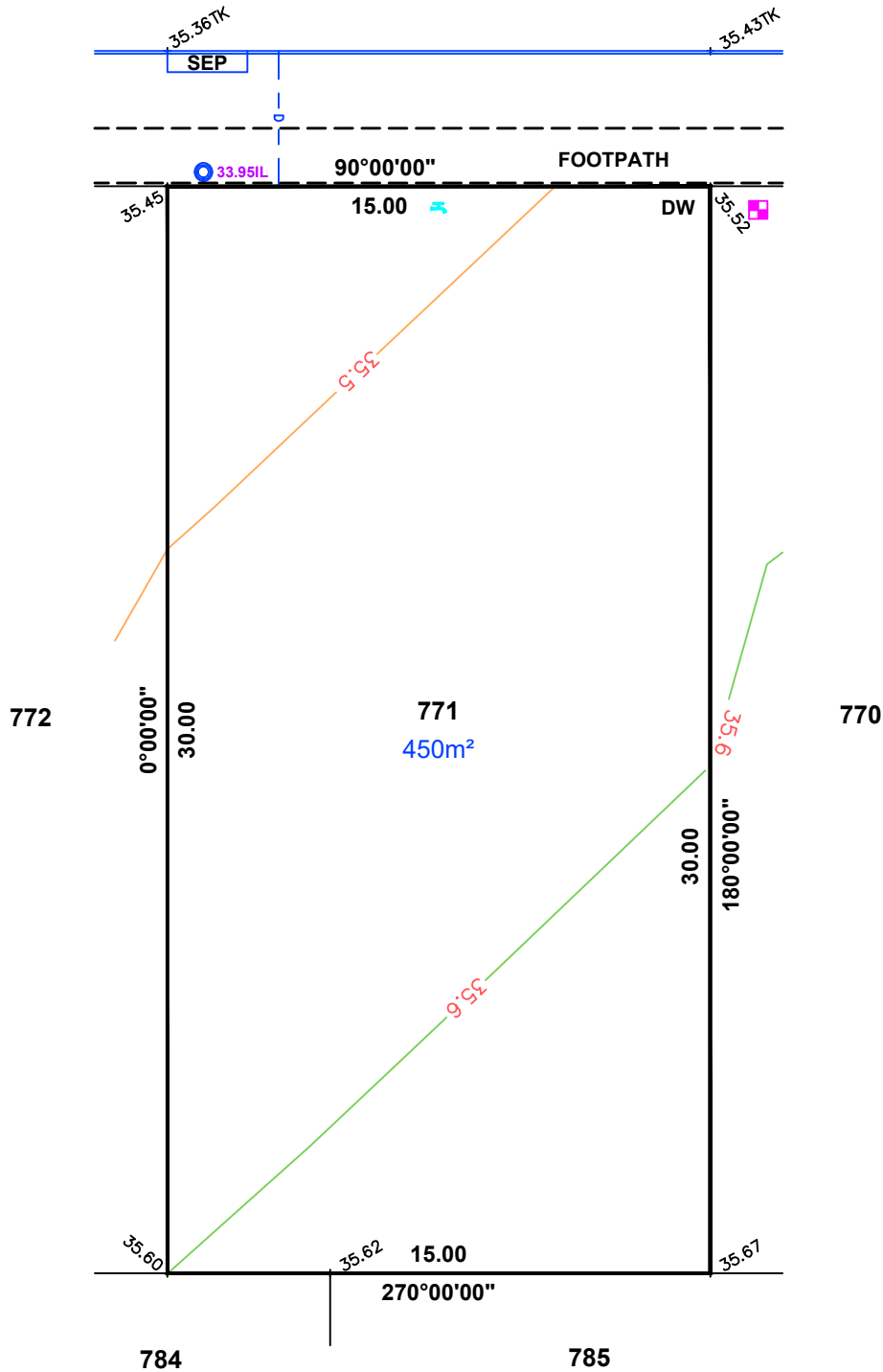

LEGEND

- WATER METER
- SEWER IP
- STOBIE POLE
- TELSTRA PIT
- S/W GRATING
- SEWER MAN HOLE
- S/W MAN HOLE
- LIGHT POLE
- E.T.S.A. CONNECTION
- TAP
- BOLLARD
- SIGN
- S/W CONNECTION
- FOOTPATH
- SIDE ENTRY PIT
- COMMON SERVICE TRENCH
- DOMESTIC
- SEWER IO
- POTABLE WATER CONN
- NON-POTABLE WATER CONN
- INVERT LEVEL
- TOP OF RETAINING WALL
- PROPOSE DRIVEWAY

NOTE:
 DRIVEWAY IN PAVERS
 BY DEVELOPER



1:200

ALEXANDER SYMONDS
 PH 8130 1666

ORIGINAL SHEET SIZE A4

IMPORTANT
 SERVICE AND DRIVEWAY LOCATIONS
 ARE APPROXIMATE. ANY CHANGES WILL
 BE AT THE PURCHASERS EXPENSE.
 PURCHASER: _____
 PURCHASER: _____
 DATE: _____

DISCLAIMER:

PLEASE NOTE THAT THIS SITE PLAN IS INTENDED FOR
 VISUAL PURPOSES ONLY. ADDITIONAL SURVEY WORK
 WILL BE REQUIRED PRIOR TO COMMENCING ANY
 DESIGN OR CONSTRUCTION ON SITE.

ALLOTMENT 772 in DEV. NO. 292/D066/12/010

in the area named
ALMOND GROVE

CT ---/----

PRELIMINARY

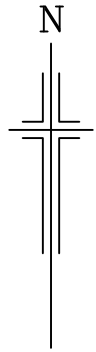

TUONO COURT

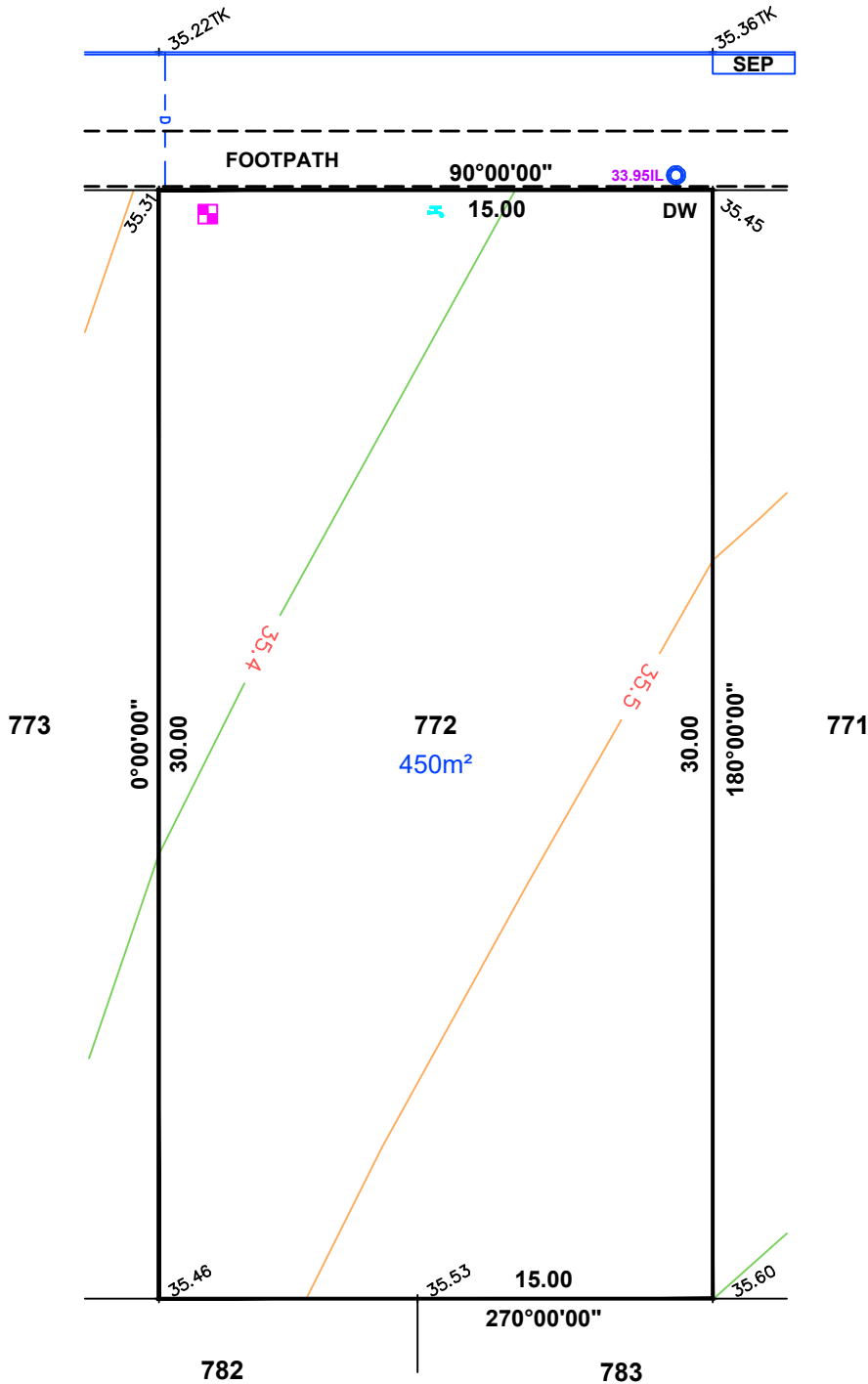

LEGEND

- WATER METER
- SEWER IP
- STOBIE POLE
- TELSTRA PIT
- S/W GRATING
- SEWER MAN HOLE
- S/W MANHOLE
- LIGHT POLE
- E.T.S.A. CONNECTION
- TAP
- BOLLARD
- SIGN
- S/W CONNECTION
- FOOTPATH
- SIDE ENTRY PIT
- COMMON SERVICE TRENCH
- DOMESTIC
- SEWER IO
- POTABLE WATER CONN
- NON-POTABLE WATER CONN
- INVERT LEVEL
- TOP OF RETAINING WALL
- PROPOSE DRIVEWAY

NOTE:
 DRIVEWAY IN PAVERS
 BY DEVELOPER



1:200

ALEXANDER SYMONDS
 PH 8130 1666

ORIGINAL SHEET SIZE A4

IMPORTANT
 SERVICE AND DRIVEWAY LOCATIONS
 ARE APPROXIMATE. ANY CHANGES WILL
 BE AT THE PURCHASERS EXPENSE.
 PURCHASER: _____
 PURCHASER: _____
 DATE: _____

DISCLAIMER:

PLEASE NOTE THAT THIS SITE PLAN IS INTENDED FOR
 VISUAL PURPOSES ONLY. ADDITIONAL SURVEY WORK
 WILL BE REQUIRED PRIOR TO COMMENCING ANY
 DESIGN OR CONSTRUCTION ON SITE.

ALLOTMENT 773 in DEV. NO. 292/D066/12/010

in the area named
ALMOND GROVE

CT ---/----

PRELIMINARY

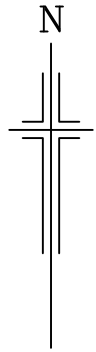

TUONO COURT

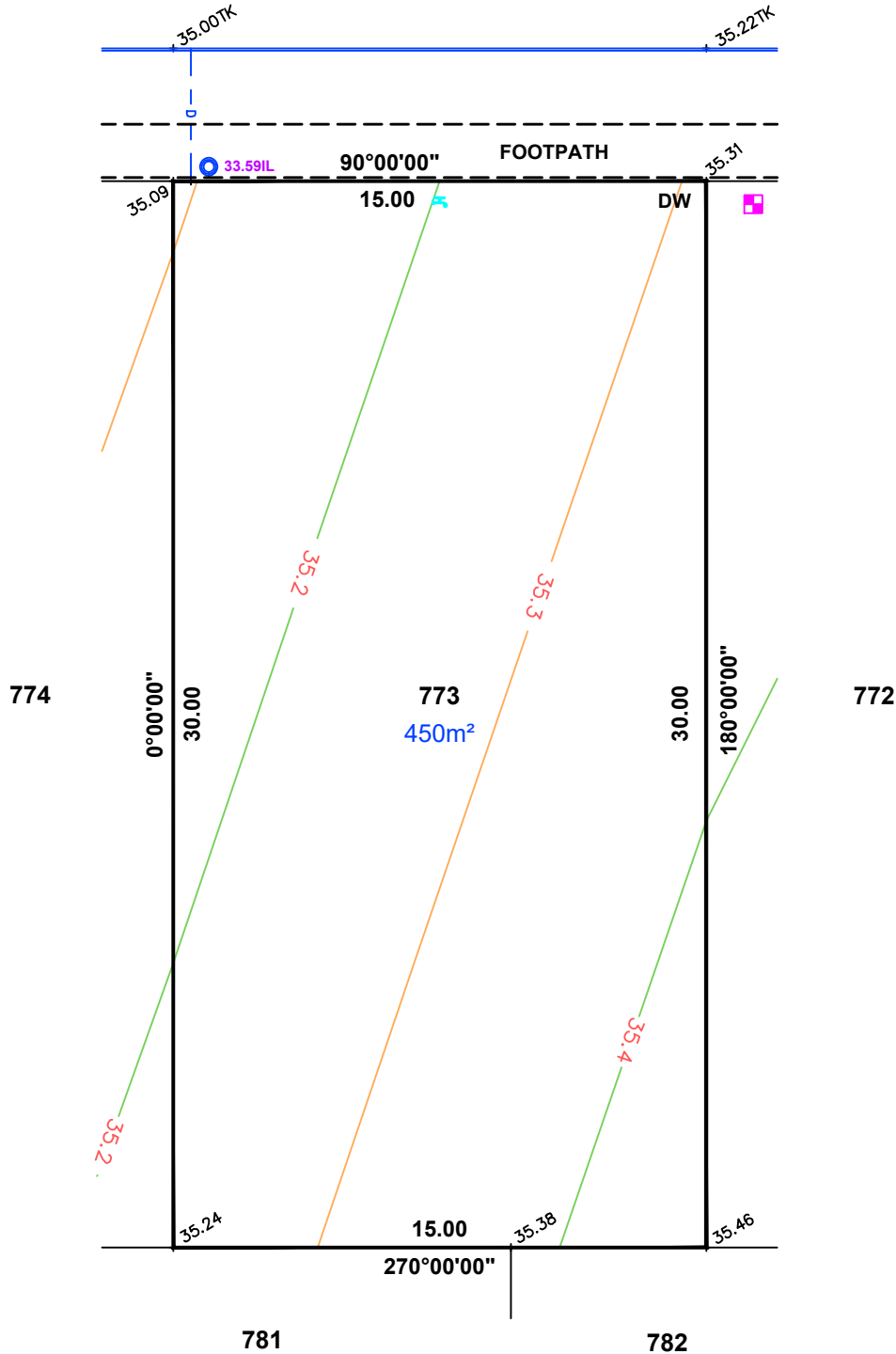

LEGEND

- WATER METER
- SEWER IP
- STOBIE POLE
- TELSTRA PIT
- S/W GRATING
- SEWER MAN HOLE
- S/W MANHOLE
- LIGHT POLE
- ETSA CONNECTION
- TAP
- BOLLARD
- SIGN
- S/W CONNECTION
- FOOTPATH
- SIDE ENTRY PIT
- COMMON SERVICE TRENCH
- DOMESTIC
- SEWER IO
- POTABLE WATER CONN
- NON-POTABLE WATER CONN
- INVERT LEVEL
- TOP OF RETAINING WALL
- PROPOSE DRIVEWAY

NOTE:
 DRIVEWAY IN PAVERS
 BY DEVELOPER



ALEXANDER SYMONDS
 PH 8130 1666

IMPORTANT
 SERVICE AND DRIVEWAY LOCATIONS
 ARE APPROXIMATE. ANY CHANGES WILL
 BE AT THE PURCHASERS EXPENSE.
 PURCHASER: _____
 PURCHASER: _____
 DATE: _____

DISCLAIMER:

PLEASE NOTE THAT THIS SITE PLAN IS INTENDED FOR
 VISUAL PURPOSES ONLY. ADDITIONAL SURVEY WORK
 WILL BE REQUIRED PRIOR TO COMMENCING ANY
 DESIGN OR CONSTRUCTION ON SITE.

ALLOTMENT 774 in DEV. NO. 292/D066/12/010

in the area named

ALMOND GROVE

CT ---/----

PRELIMINARY

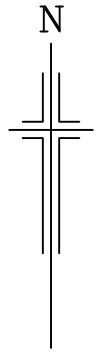

TUONO COURT

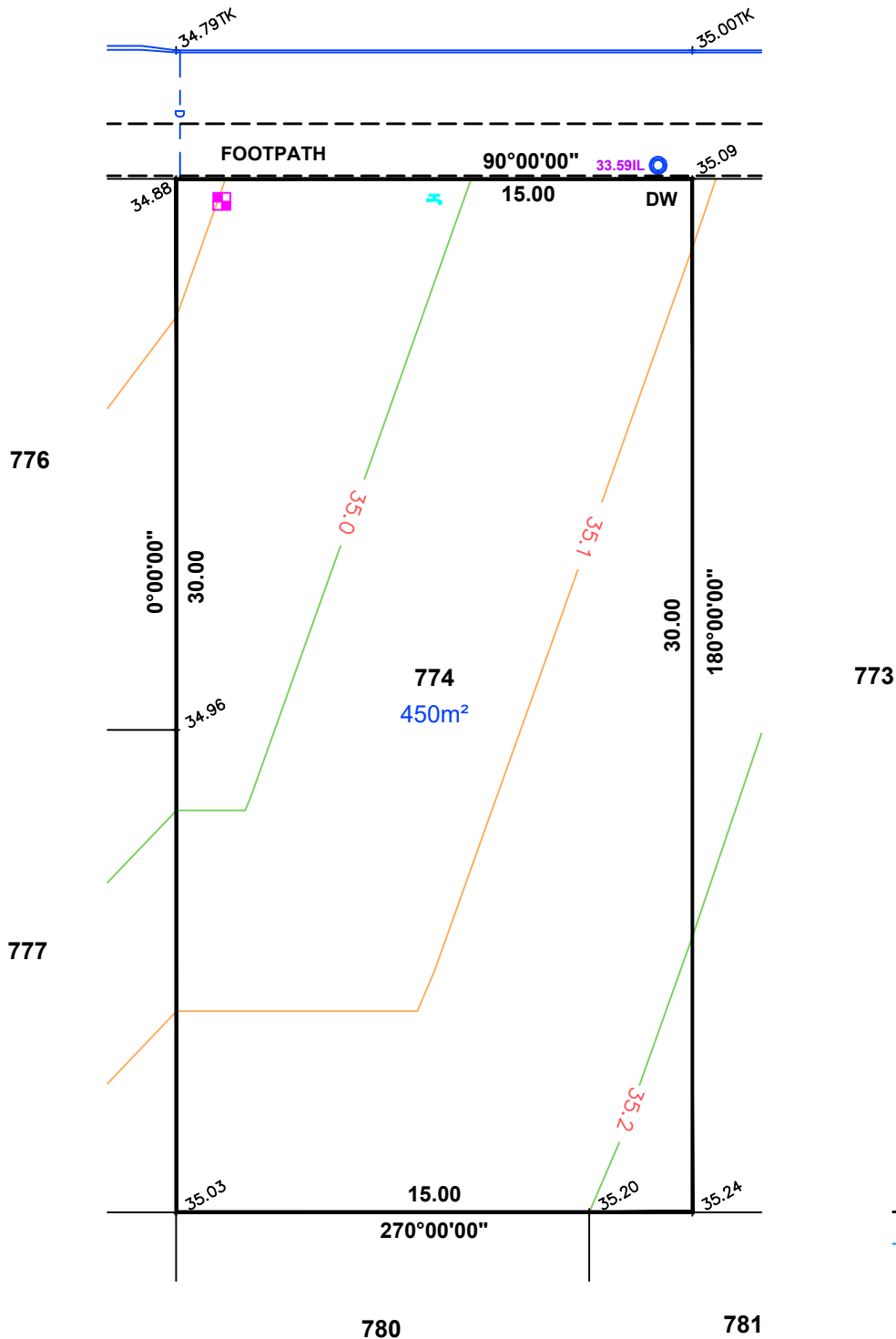

LEGEND

- WATER METER
- SEWER IP
- STOBIE POLE
- TELSTRA PIT
- S/W GRATING
- SEWER MAN HOLE
- S/W MANHOLE
- LIGHT POLE
- ETSA CONNECTION
- TAP
- BOLLARD
- SIGN
- S/W CONNECTION
- FOOTPATH
- SIDE ENTRY PIT
- COMMON SERVICE TRENCH
- DOMESTIC
- SEWER IO
- POTABLE WATER CONN
- NON-POTABLE WATER CONN
- INVERT LEVEL
- TOP OF RETAINING WALL
- PROPOSE DRIVEWAY

NOTE:
 DRIVEWAY IN PAVERS
 BY DEVELOPER



ALEXANDER SYMONDS
 PH 8130 1666

ORIGINAL SHEET SIZE A4

ALLOTMENT 776 in DEV. NO. 292/D066/12/010
in the area named
ALMOND GROVE
 CT ---/---

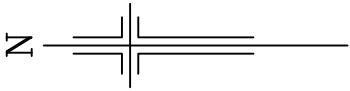

TUONO COURT

PRELIMINARY

DISCLAIMER:
 PLEASE NOTE THAT THIS SITE PLAN IS INTENDED FOR VISUAL PURPOSES ONLY. ADDITIONAL SURVEY WORK WILL BE REQUIRED PRIOR TO COMMENCING ANY DESIGN OR CONSTRUCTION ON SITE.

IMPORTANT
 SERVICE AND DRIVEWAY LOCATIONS ARE APPROXIMATE. ANY CHANGES WILL BE AT THE PURCHASERS EXPENSE.
 PURCHASER: _____
 PURCHASER: _____
 DATE: _____

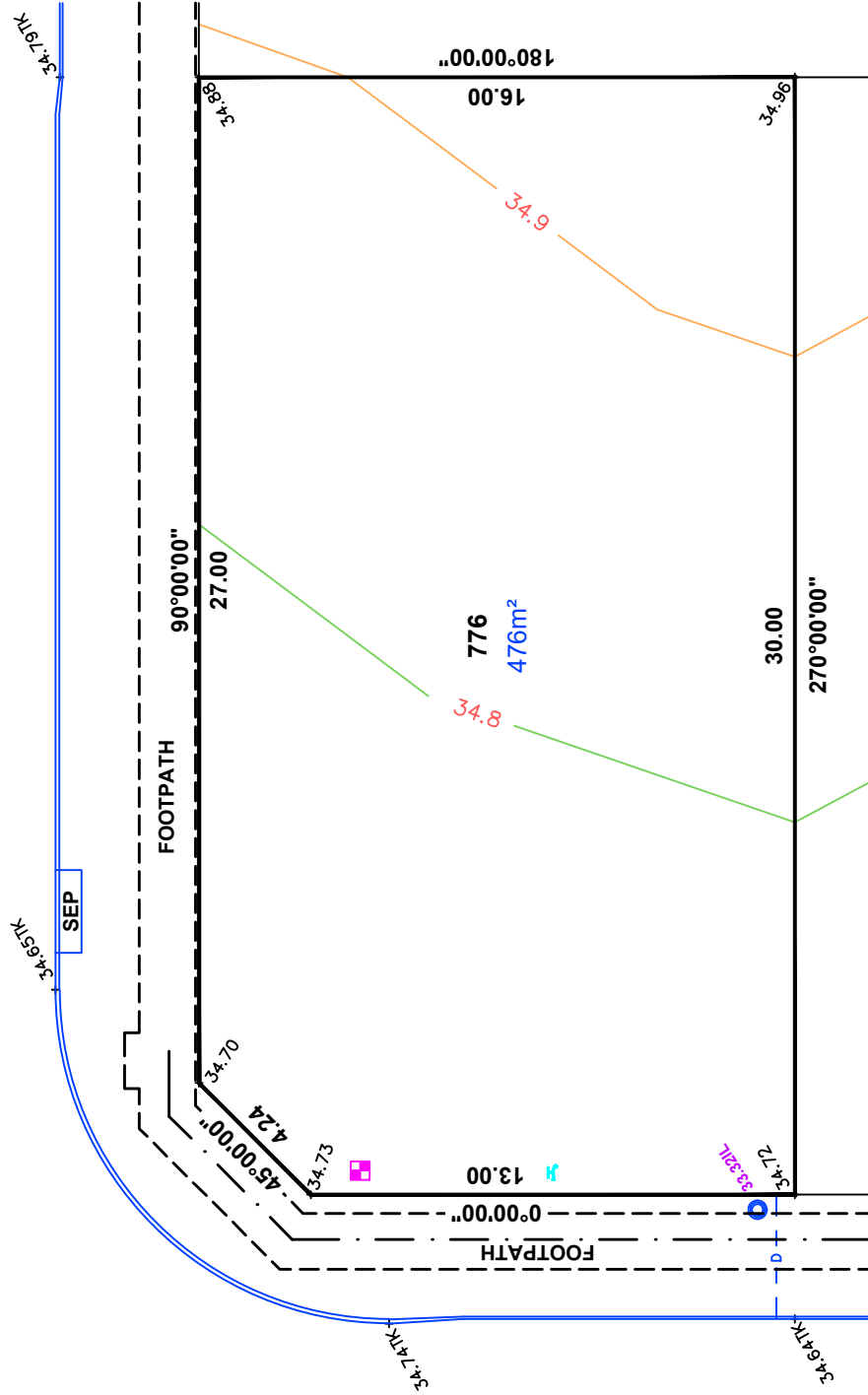

- LEGEND**
- WATER METER
 - SEWER IP
 - STOBIE POLE
 - TELSTRA PIT
 - S/W GRATING
 - SEWER MAN HOLE
 - S/W MANHOLE
 - LIGHT POLE
 - ETSA CONNECTION
 - TAP
 - BOLLARD
 - SIGN
 - S/W CONNECTION
 - FOOTPATH
 - SIDE ENTRY PIT
 - COMMON SERVICE TRENCH
 - DOMESTIC
 - SEWER IO
 - POTABLE WATER CONN
 - NON-POTABLE WATER CONN
 - INVERT LEVEL
 - TOP OF RETAINING WALL
 - PROPOSE DRIVEWAY

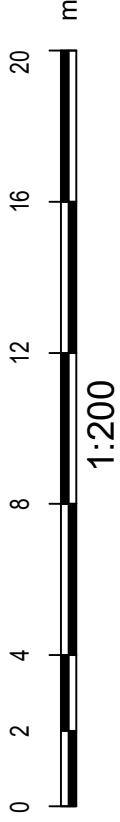

NOTE:
 DRIVEWAY IN PAVERS BY DEVELOPER

ALEXANDER SYMONDS
 PH 8130 1666

ALLOTMENT 777 in DEV. NO. 292/D066/12/010
 in the area named
ALMOND GROVE
 CT ---/---/----

PRELIMINARY

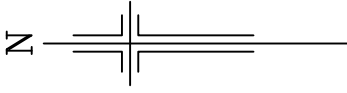

DISCLAIMER:

PLEASE NOTE THAT THIS SITE PLAN IS INTENDED FOR VISUAL PURPOSES ONLY. ADDITIONAL SURVEY WORK WILL BE REQUIRED PRIOR TO COMMENCING ANY DESIGN OR CONSTRUCTION ON SITE.

IMPORTANT
 SERVICE AND DRIVEWAY LOCATIONS ARE APPROXIMATE. ANY CHANGES WILL BE AT THE PURCHASERS EXPENSE.
 PURCHASER: _____
 PURCHASER: _____
 DATE: _____

YAMUNA AVENUE

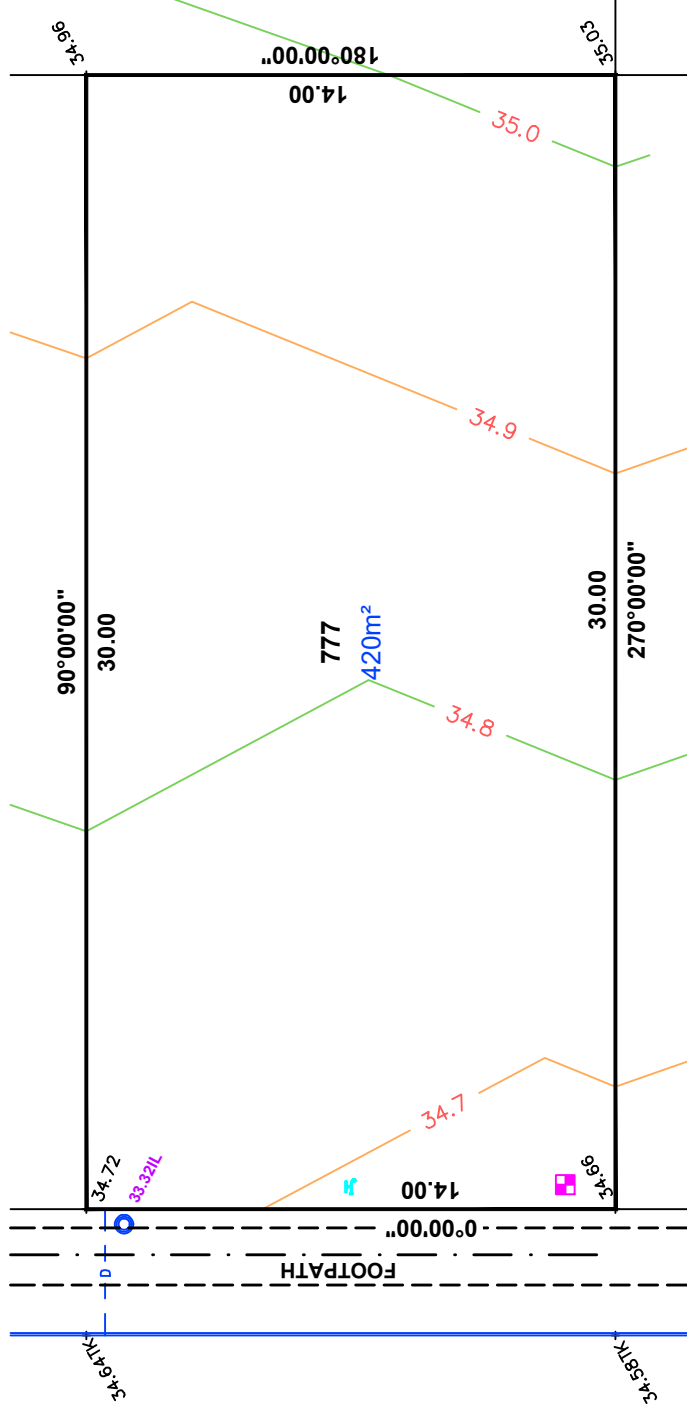

LEGEND

- WATER METER
- SEWER IP
- STOBIE POLE
- TELSTRA PIT
- S/W GRATING
- SEWER MAN HOLE
- S/W MANHOLE
- LIGHT POLE
- ETSA CONNECTION
- TAP
- BOLLARD
- SIGN
- S/W CONNECTION
- FOOTPATH
- SIDE ENTRY PIT
- COMMON SERVICE TRENCH
- DOMESTIC
- SEWER IO
- POTABLE WATER CONN
- NON-POTABLE WATER CONN
- INVERT LEVEL
- TOP OF RETAINING WALL
- PROPOSE DRIVEWAY



NOTE:
 DRIVEWAY IN PAVERS
 BY DEVELOPER

ALEXANDER SYMONDS
 PH 8130 1666

ALLOTMENT 778 in DEV. NO. 292/D066/12/010
in the area named
ALMOND GROVE

CT ---/---/----

PRELIMINARY

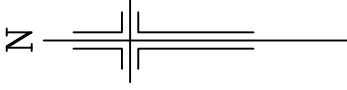

LEGEND

- WATER METER
- SEWER IP
- STOBIE POLE
- TELSTRA PIT
- S/W GRATING
- SEWER MAN HOLE
- S/W MANHOLE
- LIGHT POLE
- ETSA CONNECTION
- TAP
- BOLLARD
- SIGN
- S/W CONNECTION
- FOOTPATH
- SIDE ENTRY PIT
- COMMON SERVICE TRENCH
- DOMESTIC
- SEWER IO
- POTABLE WATER CONN
- NON-POTABLE WATER CONN
- INVERT LEVEL
- TOP OF RETAINING WALL
- PROPOSE DRIVEWAY

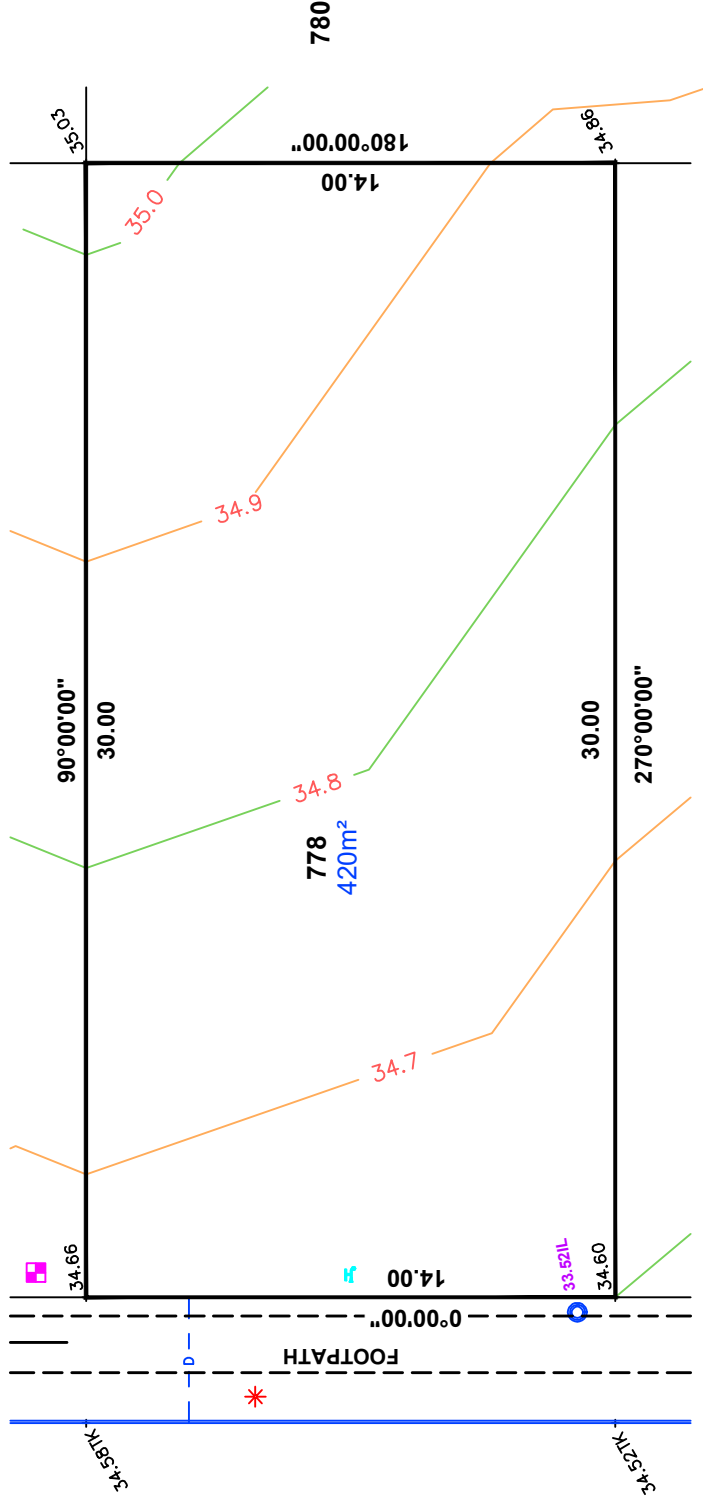

DISCLAIMER:

PLEASE NOTE THAT THIS SITE PLAN IS INTENDED FOR VISUAL PURPOSES ONLY. ADDITIONAL SURVEY WORK WILL BE REQUIRED PRIOR TO COMMENCING ANY DESIGN OR CONSTRUCTION ON SITE.

IMPORTANT
SERVICE AND DRIVEWAY LOCATIONS ARE APPROXIMATE. ANY CHANGES WILL BE AT THE PURCHASERS EXPENSE.
PURCHASER: _____
PURCHASER: _____
DATE: _____

NOTE:
DRIVEWAY IN PAVERS BY DEVELOPER

ALEXANDER SYMONDS
PH 8130 1666

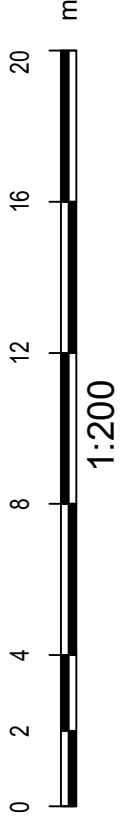

YAMUNA AVENUE